



DAMEN FAST CREW SUPPLIER® 2610

"TWIN AXE"

GENERAL

BUILDING YEAR	2014
CLASSIFICATION	Bureau Veritas I ✱ Hull •MACH Light Ship / Fast Utility Vessel Sea Area 3
FLAG	United Kingdom

DIMENSIONS

LENGTH O.A.	26.30 m
BEAM O.A.	10.40 m
DEPTH	2.90 m
DRAFT MAX.	2.40 m
TONNAGE	81 GT / 58 NT

TANK CAPACITIES

FUEL OIL	14.20 m ³
FRESH WATER	1.80 m ³
BILGE WATER/DIRTY OIL	0.40 m ³
WASTE WATER	0.50 m ³

DECK CAPACITIES

DECK LOAD	1.50 t/m ²
CLEAR DECK AREA	90 m ²

PERFORMANCES (TRIALS)

SPEED	26.1 knots
RANGE	700 nm at max. speed

PROPULSION SYSTEM

MAIN ENGINES	2x caterpillar C32 TTA
TOTAL POWER	1790 bkW
PROPULSION	Fixed-pitch propellers
GEARBOX	Reintjes ZWVS
BOWTHRUSTER	2x 50 kW hydraulically driven

AUXILIARY EQUIPMENT

AUXILIARY ENGINES	2x Caterpillar C2.2T
OUTPUT	22.5 kW / 28.0 kVA
FUEL SEPARATOR	Separ SWK 2000
INTERNAL FIFI SYSTEM	Hand operated fire extinguishers, Fixed Fi-Fi system in engine rooms (NOVEC 1230)
TRANSFER PUMPS	Fuel 2800 l/h Fresh water 800l/h

DECK LAY-OUT

ANCHOR	1x 150kg HHP Pool TW
FENDERING	Rubber "D" type and heavy duty foam filled bow fender

ACCOMMODATION

WHEELHOUSE	Mess/day-room, pantry & bridge
MAIN DECK	Wet gear room, passenger area with 12 motion dampening seats, 4-crew cabin, sanitary spaces.
AIR CONDITIONING	85.000 BTU/hr

NAUTICAL AND COMMUNICATION EQUIPMENT

All systems and equipment according to GMDSS Area 2.

SEARCHLIGHTS	1x1000W 230V
NAVIGATION EQUIPMENT	radar, GPS, AIS, echo sounder, chart plotter
COMMUNICATION	VHF, MF/HF, 2x VHF handheld, Navtex, inmarsat-C, EPIRB, SART, iridium satellite telephone

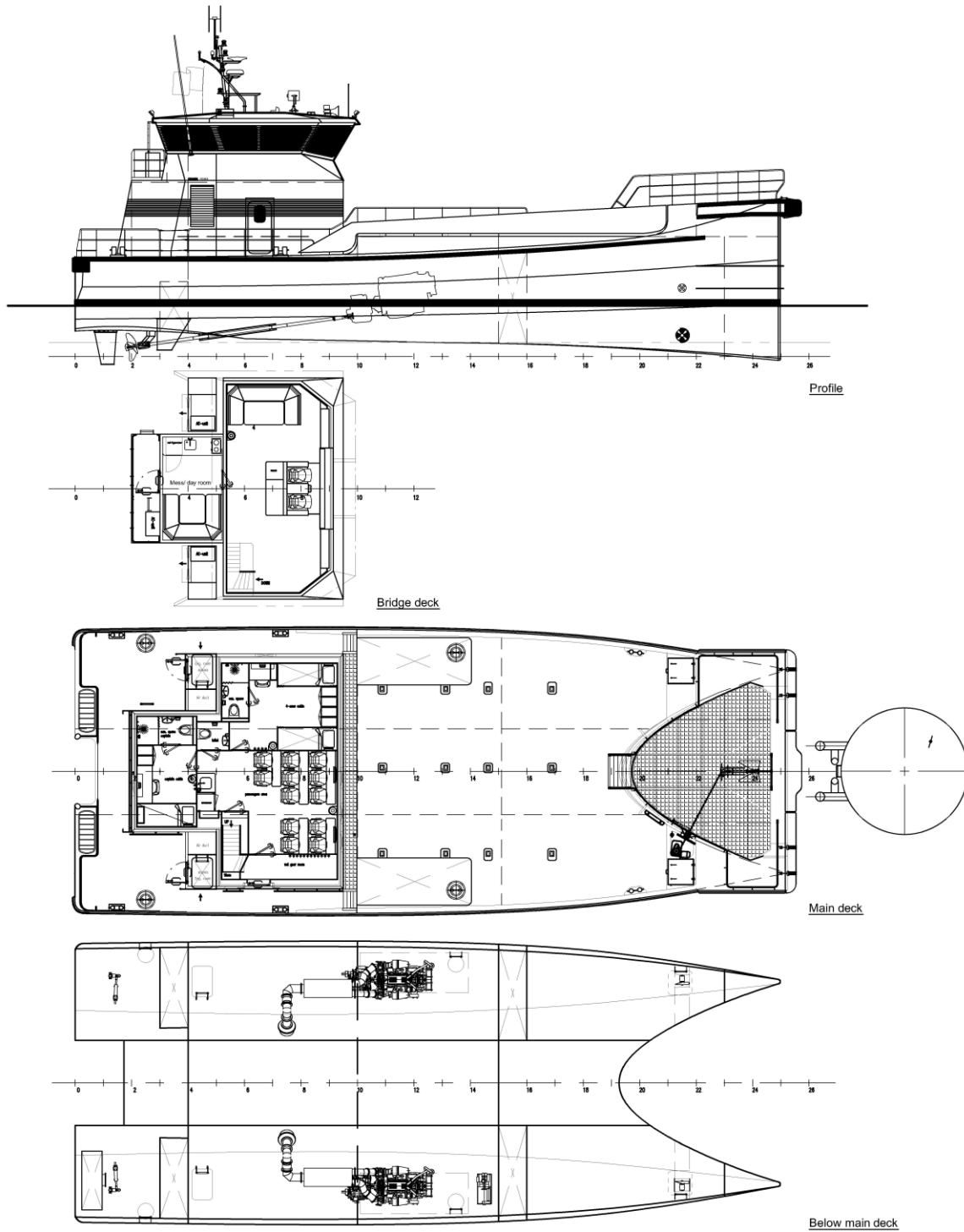

DAMEN FAST CREW SUPPLIER[®] 2610

"TWIN AXE"

DAMEN

DAMEN MARINE SERVICES

Member of the DAMEN SHIPYARDS GROUP



Industrieterrein Avelingen West 20
4202 MS Gorinchem

P.O. Box 1
4200 AA Gorinchem
The Netherlands

phone +31 (0)183 65 46 60
fax +31 (0)183 63 94 40

info-dms@damen.com
www.dms.nl