

アイヌと歩む。  
Together with the Ainu

Ainu Museum and Park)

Participatory open-air museum

National Ainu Park



About the nickname "Upopoy"

Upopoy is an Ainu term meaning "singing in a large group."

Note: The conceptual drawing above was made in the design phase and is subject to change.

General Information

Hours (Provisional) 9:00 – 17:00  
Closed: Mondays (or Tuesday if Monday is a national holiday) and year-end and New Year's holidays

- Facilities
- Multilingual explanations
  - Wheelchair accessibility
  - Wheelchair and stroller rental availability
  - Free Wi-Fi connectivity

Note: Admission fees and other details are under consideration.

Dining and Retail Services

Entrance Center: Restaurant and food court  
Upopoy has a restaurant with a beautiful view of Lake Poroto and a food court where visitors can enjoy meals chosen from an extensive menu.

Entrance Center: Shop  
Not only does this shop sell Ainu crafts and other items for gifts and souvenirs, but it also offers light meals, such as boxed meals and bread, drinks and everyday items.

National Ainu Museum: Shop  
This shop sells Ainu crafts and books related to the museum exhibition. It also includes a relaxing space with a great view of the park.

Access Great access, approx. 1 hour from Sapporo and approx. 40 minutes from New Chitose Airport

Access by air

Tokyo → New Chitose Airport Approx. 1 hr. 40 min. Osaka → New Chitose Airport Approx. 2 hr.

Access from major cities in Hokkaido

Sapporo [Sapporo-kita IC] Approx. 65 min. via expressway [JR Sapporo Station] Approx. 65 min. by limited-express train  
Asahikawa [Asahikawa Takasu IC] Approx. 2 hr. 20 min. via expressway [JR Asahikawa Station] Approx. 2 hr. 30 min. by limited-express train

New Chitose Airport [New Chitose Airport IC] Approx. 40 min. via expressway [JR New Chitose Airport Station] Approx. 40 min. by limited-express train  
Hakodate [Onumakoen IC] Approx. 2 hr. 50 min. via expressway [JR Hakodate Station] Approx. 3 hr. by limited-express train

Note: The above travel times are a rough guide and do not include transfer times.

Access within Shiraoi Town

Approx. 10 min. on foot from Shiraoi Station  
Approx. 10 min. by car from Shiraoi IC

[Parking]

Approx. 240 passenger cars  
Approx. 80 large vehicles

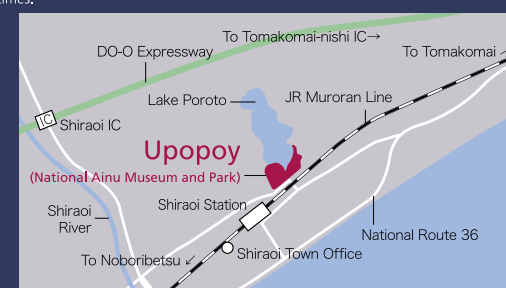

Address: Wakakusa-cho 2-chome, Shiraoi, Shiraoi-gun, Hokkaido

Tourist Information in Surrounding Areas



Nature

The region where Upopoy is located abounds in natural attractions, including Lake Poroto and Poroto Forest (Shiraoi Town), Toya-Utsu UNESCO Global Geopark (Toyako Town and other municipalities) and Cape Chikyu (Muroran City).



Hot springs

The region is home to various hot springs whose waters feature different chemical properties. These include the Kojohama, Noboribetsu, Karurusu, Lake Toya and Kitayuzawa hot springs. It's a great destination for hot spring tours.



Food

The region is a great place for foodies, with a wealth of fine cuisine, including Shiraoi beef, Kojohama salted cod roe, crab and other seafood, as well as dairy products made using fresh milk from Noboribetsu and Date cities.



Tour programs

The region offers various tours, including factory night-view cruises (Muroran City), canoeing tours at Lake Shikotsu (Chitose City) and indigo-dyeing activities (Date City).

Contact

The Foundation for Ainu Culture (operating body) E-mail: info@ainu-upopoy.jp, Tel: 011-206-7427 (Hours: 9:00 – 17:00, weekdays only)

Check the Upopoy portal for the latest information. <https://ainu-upopoy.jp/>

Published in March 2019

アイヌが歩む。  
アイヌと歩む。

The Ainu Together  
Together with the Ainu



アイヌが歩む。  
The Ainu Together

Upopoy (National

Japan's first national museum featuring the indigenous Ainu people  
National Ainu Museum

What is Upopoy (the National Ainu Museum and Park)?

Upopoy serves as the national center for the revival and development of Ainu culture—an invaluable culture in Japan that's on the verge of extinction. Visitors can appreciate the rich culture of the Ainu amidst the natural splendor of the Lake Poroto area.

Major facilities of Upopoy

◆ National Ainu Museum  
As Japan's first national museum featuring the indigenous Ainu people, this museum exhibits various objects that introduce the history and culture of the Ainu from their own perspective.

◆ National Ainu Park  
This participatory open-air museum enables visitors to experience various elements of Ainu culture through appreciation of traditional dance performances and participation in wide-ranging hands-on programs.

◆ Memorial Site  
The Memorial Site will be developed to realize dignified memorial services conducted by Ainu. It will be located on high ground on the east side of Lake Poroto.

2020.4.24 OPEN



Shiraoi, Hokkaido



A museum that does more than just display objects: It also provides visitors with new discoveries

Japan has seven national museums, in Tokyo, Kyoto, Fukuoka and elsewhere. The National Ainu Museum will become the first national museum in Hokkaido and the northernmost national museum in Japan. Shifting away from an exclusive focus on traditional Ainu culture, the museum will also highlight the diversity of contemporary Ainu culture and people from various perspectives.

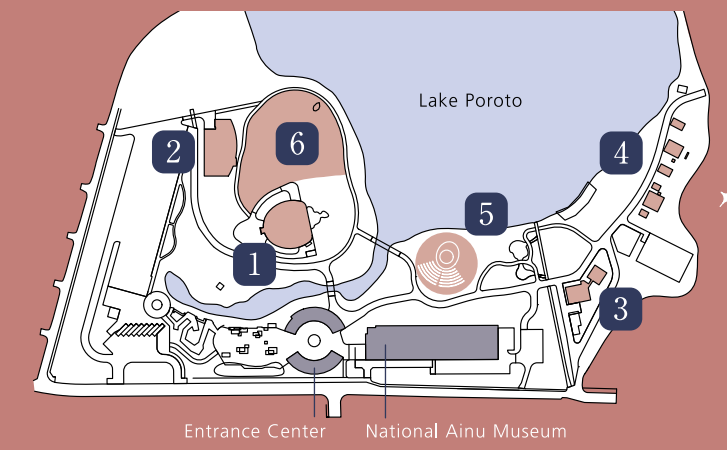
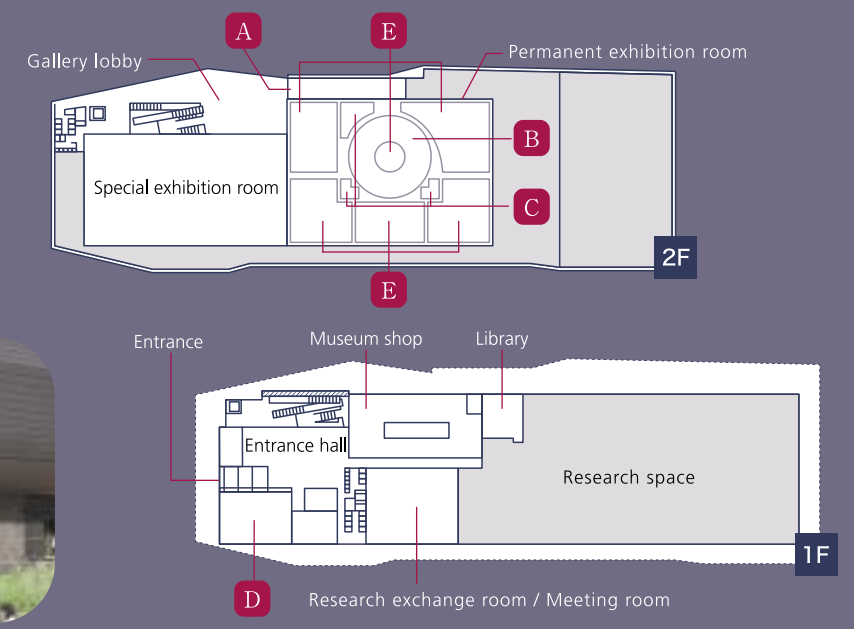

- 1 Cultural Exchange Hall (Capacity: 530 people)
- 2 Workshop (Capacity: 400 people)
- 3 Crafts Studio
- 4 Kotan (traditional Ainu village)
- 5 Cikasani Square
- 6 Lawn Square



Immerse yourself in the culture of the indigenous Ainu people, which has been cultivated amidst nature

The National Ainu Park is an open-air museum where visitors can experience various elements of Ainu culture—a culture that has been cultivated amidst nature. Here, visitors can watch traditional dance performances and participate in wide-ranging hands-on programs. The park is also a place where visitors can relax and appreciate Ainu culture amidst natural splendor.



## Mission of the National Ainu Museum

The mission of the National Ainu Museum is to promote a proper understanding and awareness of Ainu history and culture in Japan and elsewhere out of respect for the dignity of the indigenous Ainu people while contributing to the creation and development of new aspects of Ainu culture.

The museum will provide explanatory panels, signs and audio guides in multiple languages, including Ainu, Japanese and English.



- A Introduction**  
Introducing visitors to the Ainu and other peoples around the world, this exhibition piques one's curiosity of what will follow as one proceeds to the gallery.
- B "Plaza" exhibition**  
This exhibition at the plaza right in the middle of the permanent exhibition room gives an overview of Ainu culture through representative artifacts arranged under six themes. The exhibition enables visitors with time constraints to learn the basics of the culture.



**C Interactive Gallery**  
These exhibitions introduce children and parents to Ainu culture by using learning tools and kits which are available based on six themes. The exhibitions are also designed to help deepen their understanding of the exhibits in the permanent exhibition room and of Ainu cultures.

**D Theater**  
An approximately 100-seat theater with a large high-definition screen will show films that plainly illustrate various aspects of Ainu culture. (Time required: approx. 20 min.)

## E Exhibits displayed from the Ainu perspective under six themes

**● Our Language**  
Using sound and videos, this section highlights traditional Ainu oral literature, the basic structure of Ainu, and Ainu place-names, among other topics.



**● Our History**  
This section provides an easy-to-understand visual introduction to the history of the Ainu in both time and space, using a history wall that incorporates a map and a chronological table.

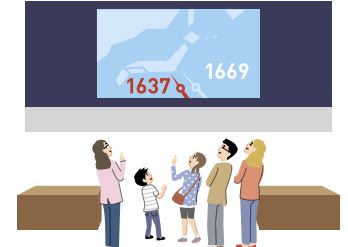

**● Our Universes**  
To help visitors learn about Ainu views of the world, this section highlights their ideas about *kamuy* (gods) and their views of nature, life and death. Exhibits include implements for rituals.

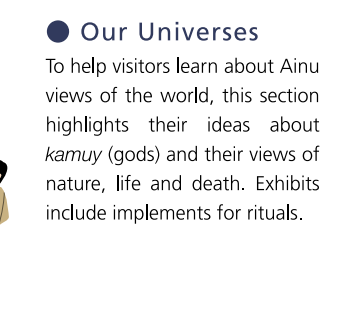

**● Our Work**  
This section highlights traditional Ainu livelihoods, such as hunting, fishing, gathering and farming, and the various occupations in which Ainu people earn their living today.

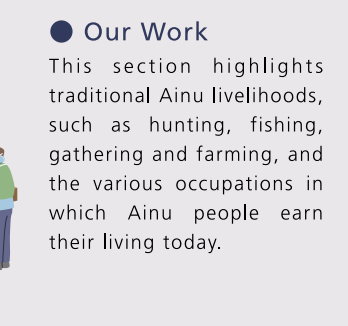

**● Our Lives**  
This section highlights various aspects of Ainu lifestyles, including food, clothing and shelter, and music and dance, introducing visitors to the characteristics and regional variations of their culture and initiatives undertaken by those handing down the culture.



**● Our Exchange**  
Exhibits here, including items obtained from trade, will help visitors retrace the footsteps of Ainu people in their exchanges with surrounding peoples. Exhibits also indicate how multicultural coexistence should be in Japan in the future.



## Various programs in which to experience Ainu culture

### Traditional performing arts 1 4 5

Visitors can enjoy performances of traditional Ainu dance, which is listed by UNESCO as an Intangible Cultural Heritage, of a *mukkuri* (a kind of mouth harp) and of a *tonkori* (a five-stringed instrument). Participatory programs are also available.



### Cooking and dining 2 4

Visitors can learn the depth of the food culture of Ainu people through food-processing and cooking activities, as well as by eating traditional Ainu dishes.



### Traditional games 2 4

Visitors can learn about Ainu culture by engaging in traditional games played by Ainu children.



### Playing of musical instruments 2 4

Visitors can try playing traditional Ainu musical instruments, such as a *mukkuri* (a kind of mouth harp) and a *tonkori* (a five-stringed instrument), in order to enjoy their sounds. A *mukkuri*-making activity will also be available.



Look  
Touch  
Feel  
Relax

A place where visitors can relax and appreciate Ainu culture amidst natural splendor



### Appreciating seasonal natural beauty

Upopoy is located at the edge of a dense forest and surrounded by terraced fields. One of the appeals of the National Ainu Park is the vegetation. Visitors can learn Ainu views of nature through programs for the appreciation of trees and wild grasses.



**Traditional craft-making 3**  
Visitors can try their hand at woodcarving and at embroidering Ainu patterns.

