



Route Log and Progress Chart

DRAFT

Please Note: Errors and Omissions May Exist.
Contact the VTrans Mapping Section with questions or concerns.

DISTRICT	TOWN	ROUTE
2	GUILFORD	Min-0508

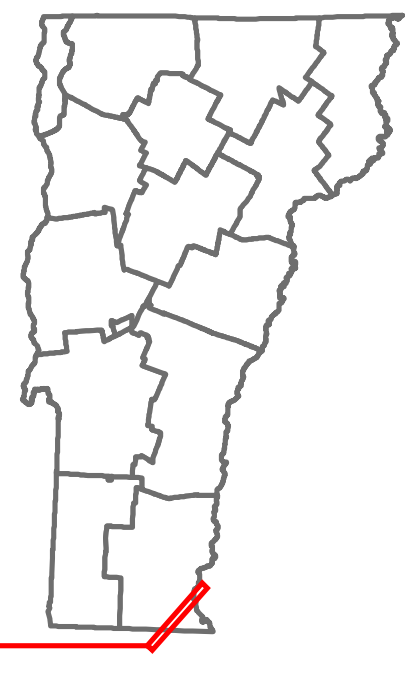

Min-0508

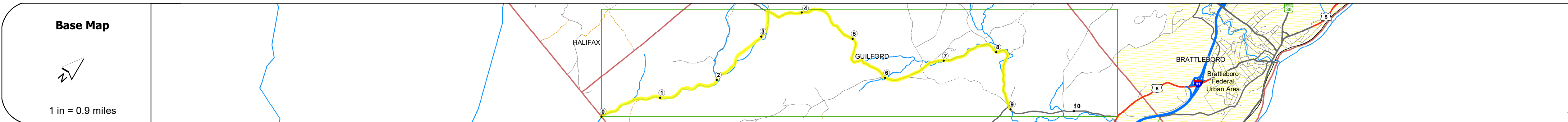

Stick Diagram

- Town Center
- Intersecting State Routes (excl. ramps/approaches)
- Other Intersecting Highways, Ramps, Approaches
- Railroad Crossings
- Primary Structures
- Secondary Structures
- Divided State Highway
- State Highway
- Divided Town Highway
- Town Highway
- Streams (Hydraulic Structure)
- Town Boundary
- Village/UC Boundaries
- District Boundaries
- State/Town Highway Change
- Divided Highway Limits
- Ghost Section Boundary
- Federal Urban Area Limits

Scale: 1 INCH = 2,000 FEET

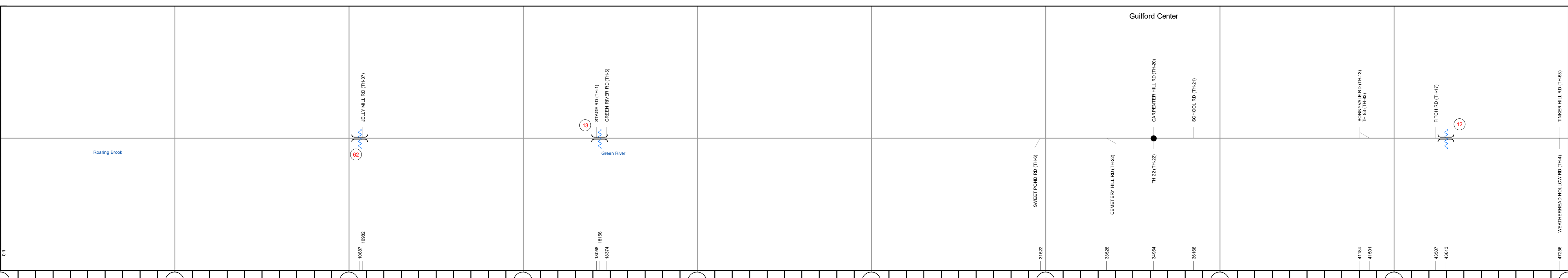

STRUCTURE DESCRIPTIONS	
Bridge 62: Stringer/multi-beam or girder - 1939 Structure No. 101307006213071 Length: 50' Width: 24.0' Facility Carried: C3007 Structure Type: ROLLED BEAM Features Intersected: ROARING BROOK Maintenance/Ownership: Town	
Bridge 13: Truss - thru - 1870 Structure No. 101307001313071 Length: 107' Height: 9.42' Width: 12.5' Weight Limit: 8 Facility Carried: C2001 Structure Type: TOWN LATTICE COV BR Features Intersected: GREEN RIVER 1 Covered: 1 Surface: Timber Maintenance/Ownership: Town	
Bridge 12: Stringer/multi-beam or girder - 1939 Structure No. 101307001213071 Length: 90' Width: 20.8' Facility Carried: C2001 Structure Type: ROLLED BEAM Features Intersected: BROAD BROOK Surface: Bituminous Maintenance/Ownership: Town	

	0	1	2	3	4	5	6	7	8	9
Road Widths							22			
Travellane										
Roadway										
Lane Count										
Base										
Subbase										
Curves										
Grades										
Guardrails										
Rumblestrips										
Historic Projects										
Maintenance Garage										
Speed Zone										
Functional Class							6			
National Highway System										
Limited Access Highway										
Customer Service Level										
Traffic Counters										
AA DT	2018									
	2017									
	2016									
	2015									
	2014									
Crash Locations	2018									
	2017									
	2016									
	2015									
	2014									

Historic Projects	Functional Class	Curves	Grades	Traffic Counters	Crash Locations	Mileage by Functional Class By Sheet	Mileage by Town By Sheet	DISTRICT	TOWN	Date: 12/02/19	ROUTE
<ul style="list-style-type: none"> Unknown Bituminous Concrete Retreatment Resurface Bituminous Mix Skinny Mix Bituminous Seal 	<ul style="list-style-type: none"> 1 - Interstate System 2 - Other Freeways and Expressways 3 - Principal Arterial 4 - Minor Arterial 5 - Major Collector 6 - Minor Collector 	<ul style="list-style-type: none"> Left (down) Right 	<ul style="list-style-type: none"> grade up grade down 	<ul style="list-style-type: none"> Continuous (CTC) Weight-In-Motion (WIM) Short-Term, Scheduled Short-Term, Unscheduled 	<ul style="list-style-type: none"> Fatal Injury Property Damage Only Unknown Crash Type 	0508 6 - minor collector 9.000	GUILFORD - S05081307 9.0 of 10.69	2	GUILFORD	1 of 2 TWN mileage: 0.0 to 9.0	Min-0508 ETE mileage: 0.0 to 9.0
<p>Indicated plans available - http://vtransmap01.ad.state.vt.us/tp/dgr/DWebstore/</p>						<p>Page Total Mileage: 9.000 mi</p>		<p>Page Total Mileage: 9.0 mi</p>		<p>For More Information Contact - Vermont Agency of Transportation, Policy, Planning and Intermodal Development Division - Mapping Section, 1 National Life Drive, Montpelier, VT 05633-5001 Telephone: 802-828-2600.</p>	