



Route Log and Progress Chart

DRAFT

Please Note: Errors and Omissions May Exist.
Contact the VTrans Mapping Section with questions or concerns.

DISTRICT	TOWN	ROUTE
8	ST. ALBANS TOWN	Min-0787

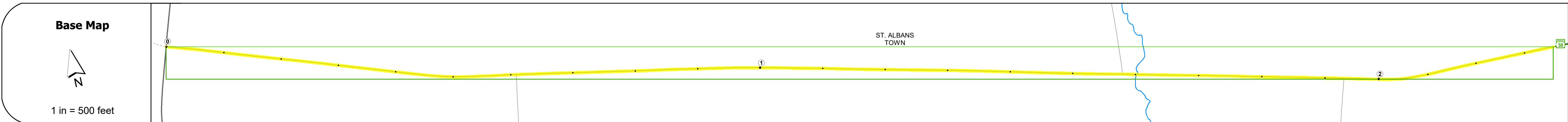
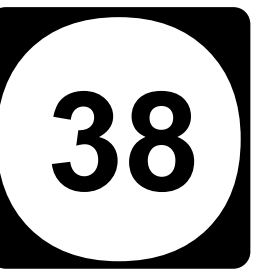
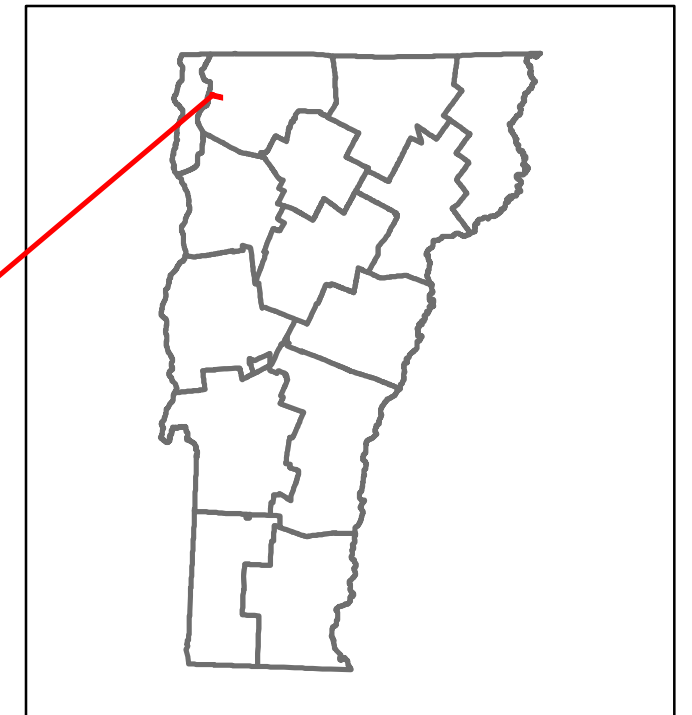

Road Widths	Travellane Roadway Lane Count Base Subbase	22 22	2	24 24
Curves				
Grades				
Guardrails				
Rumblestrips				
Historic Projects				
Maintenance Garage				
Speed Zone				
Functional Class		6		
National Highway System				
Limited Access Highway				
Customer Service Level				
Traffic Counters				
AAADT	2018 2017 2016 2015 2014			
Crash Locations	2018 2017 2016 2015 2014			

STRUCTURE DESCRIPTIONS	

Historic Projects Unknown, Retreatment, Resurface, Bituminous Mix, Skiny Mix, Bituminous Seal, Surface Treated Gravel, Plant Mix, Reclaimed Base and Bituminous Concrete	Functional Class 1- Interstate System, 2- Other Freeways and Expressways, 3- Principal Arterial, 4- Minor Arterial, 5- Major Collector, 6- Minor Collector	Curves Left, Right, Grades (degrees), Left (special), Right (special), grade up, grade down	Traffic Counters Continuous (CTC), Weigh-In-Motion (WIM), Short-Term, Scheduled, Short-Term, Unscheduled	Crash Locations Fatal, Injury, Property Damage Only, Unknown Crash Type, High Crash Locations (HCL's)	Mileage by Functional Class By Sheet 0787 6 - minor collector 2.360	Mileage by Town By Sheet ST. ALBANS TOWN - S07870613 2.36 of 2.36	DISTRICT 8	TOWN ST. ALBANS TOWN	Date: 12/05/19	ROUTE Min-0787
					Page Total Mileage: 2.360 mi	Page Total Mileage: 2.36 mi	1 of 1 TWN mileage: 0.0 to 2.36 ETE mileage: 0.0 to 2.36	ETE mileage: 0.0 to 2.36		

For More Information Contact - Vermont Agency of Transportation, Policy, Planning and Intermodal Development Division - Mapping Section, 1 National Life Drive, Montpelier, VT 05633-5001 Telephone: 802-828-2600.