



Route Log and Progress Chart

DRAFT

Please Note: Errors and Omissions May Exist.
Contact the VTrans Mapping Section with questions or concerns.

DISTRICT	TOWN	ROUTE
9	AVERILL	VT-114

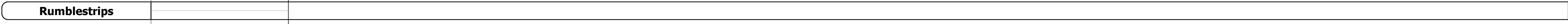
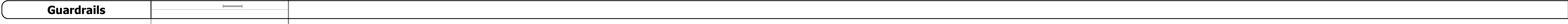
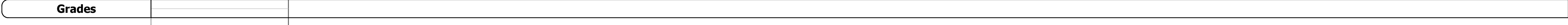
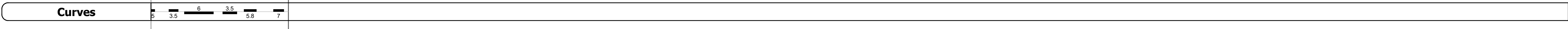
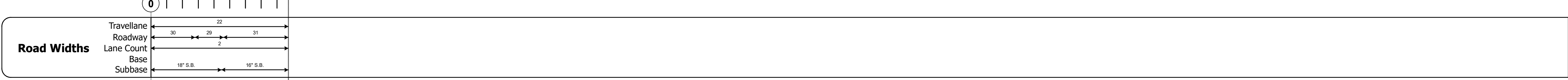
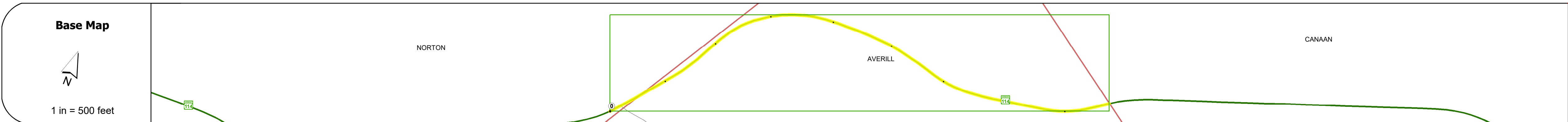
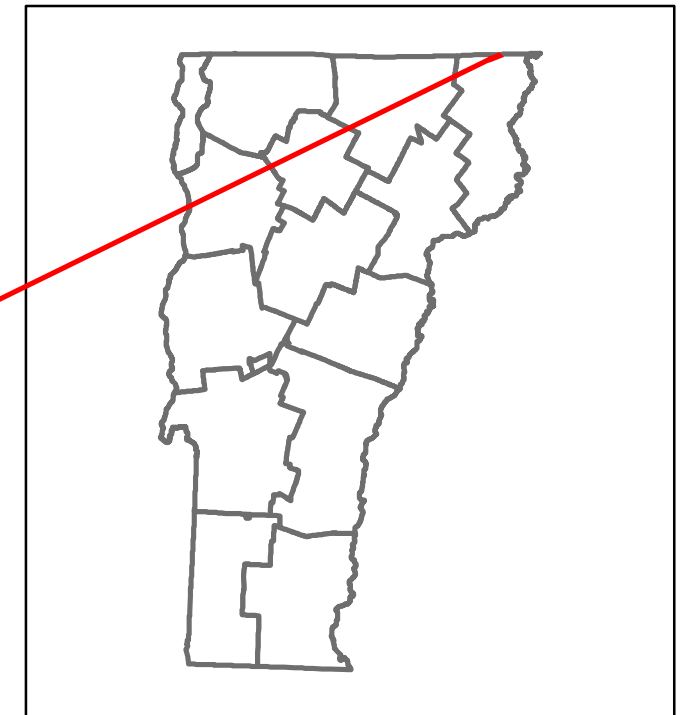

Historic Projects
2008: STP SURF(13)
2002: STP 2222(18)
1982: Unknown
1973: Unknown
1954: S 209(2)
1957: S 209(4)

Maintenance Garage: District 9 - HWY Maintenance Brighton Garage

Speed Zone:

Functional Class: 5

National Highway System:

Limited Access Highway:

Customer Service Level: Local Connector

Traffic Counters:

Year	ADT
2018	600
2017	600
2016	590
2015	590
2014	600

Year	Crash Locations
2018	
2017	
2016	
2015	
2014	

STRUCTURE DESCRIPTIONS

--	--

Historic Projects Unknown, Retreatment, Resurface, Bituminous Mix, Skiny Mix, Bituminous Seal, Bituminous Concrete, Cold Plane and, Reclaimed Base and, Concrete, Surface Treated, Gravel, Plant Mix, Bituminous Concrete	Functional Class 1 - Interstate System, 2 - Other Freeways and Expressways, 3 - Principal Arterial, 4 - Minor Arterial, 5 - Major Collector, 6 - Minor Collector	Curves Left (degrees), Right (degrees), Grades (degrees), grade up, grade down	Traffic Counters Continuous (CTC), Weigh-In-Motion (WIM), Short-Term, Scheduled, Short-Term, Unscheduled (counter ID)	Crash Locations Fatal, Injury, Property Damage Only, Unknown Crash Type, High Crash Locations (HCL's) Sections (& Intersections)	Mileage by Functional Class By Sheet 0320 5 - Major collector 0.872	Mileage by Town By Sheet AVERILL - V114-0501 0.872 of 0.872	DISTRICT 9	TOWN AVERILL	Date: 12/22/19	ROUTE VT-114
					Speed Zones 15, 30, 35, 40, 45, 50, 55, 60, 65	Road Widths (ft)	ADT (AADT)	Page Total Mileage: 0.872 mi	Page Total Mileage: 0.872 mi	1 of 1 TWN mileage: 0.0 to 0.872