



## TWO MILE SCHOOL

288 Bruce Hwy, Two Mile

### Place Details

|                         |                        |
|-------------------------|------------------------|
| PROPERTY DESCRIPTION:   | 5 on SP104250          |
| PLACE NAME:             | Two Mile School        |
| ORIGINAL USE:           | Education              |
| DATE OF CONSTRUCTION:   | Unknown                |
| AREA (m <sup>2</sup> ): | 38380.00m <sup>2</sup> |
| ASSESSMENT NUMBER:      | 1083                   |
| PARCEL NUMBER:          | 148                    |
| OWNER:                  | State of Queensland    |
| HERITAGE SIGNIFICANCE:  | Local                  |
| CULTURAL SIGNIFICANCE:  | Historical, Social     |



Photo sourced from Mark Baker Town Planning Consultants Pty Ltd in association with Ivan Mc Donald Architects

### Historical Data

Two Mile School was erected in 1883. The school was later resisted and rebuilt before being destroyed by fire in 1959. The school residence is reputed to be the oldest building in Two Mile.

### Place Assessment

Unknown

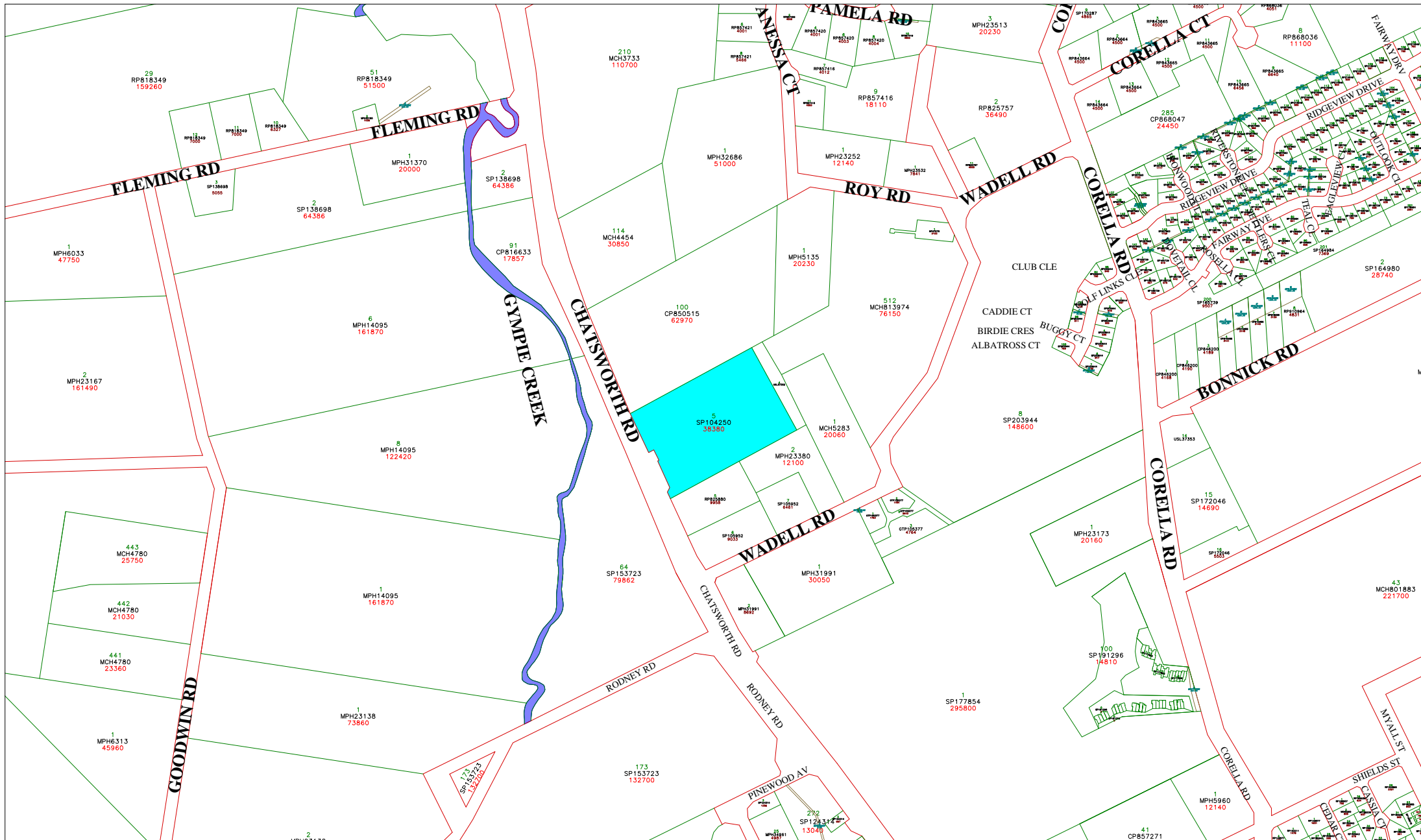

- Easement
- Property Polygons
- Water Body
- Road
- Lot Boundary

Map 30 - Two Mile School

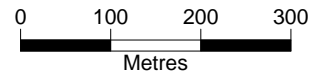

Scale: 1:8385.643



**GYMPIE REGIONAL COUNCIL**  
 Copyright © The State of Queensland  
 (Department of Lands) 1994

Please note that the accuracy of the information hereon is not guaranteed. The information is indicative only and is meant only as a guide. You should therefore undertake your own site inspection and survey to provide the information you are seeking. No liability is accepted by the Council for any error or omission or loss incurred by reliance being placed on the information contained on this plan and/or search.

Date: 5/12/2008  
 Time: 15:13