



AMAMOOR HALL

31-33 Busby St, Amamoor

Place Details

PROPERTY DESCRIPTION:	11 on RP7008
PLACE NAME:	Amamoor Hall
ORIGINAL USE:	Indoor Recreation
DATE OF CONSTRUCTION:	1921
AREA (m ²):	1012.00m ²
ASSESSMENT NUMBER:	5165
PARCEL NUMBER:	14108
HERITAGE SIGNIFICANCE:	Local
CULTURAL SIGNIFICANCE:	Historical, Social



Photo sourced from Mark Baker Town Planning
Consultants Pty Ltd in association with
Ivan Mc Donald Architects

Historical Data

Unknown

Place Assessment

Unknown

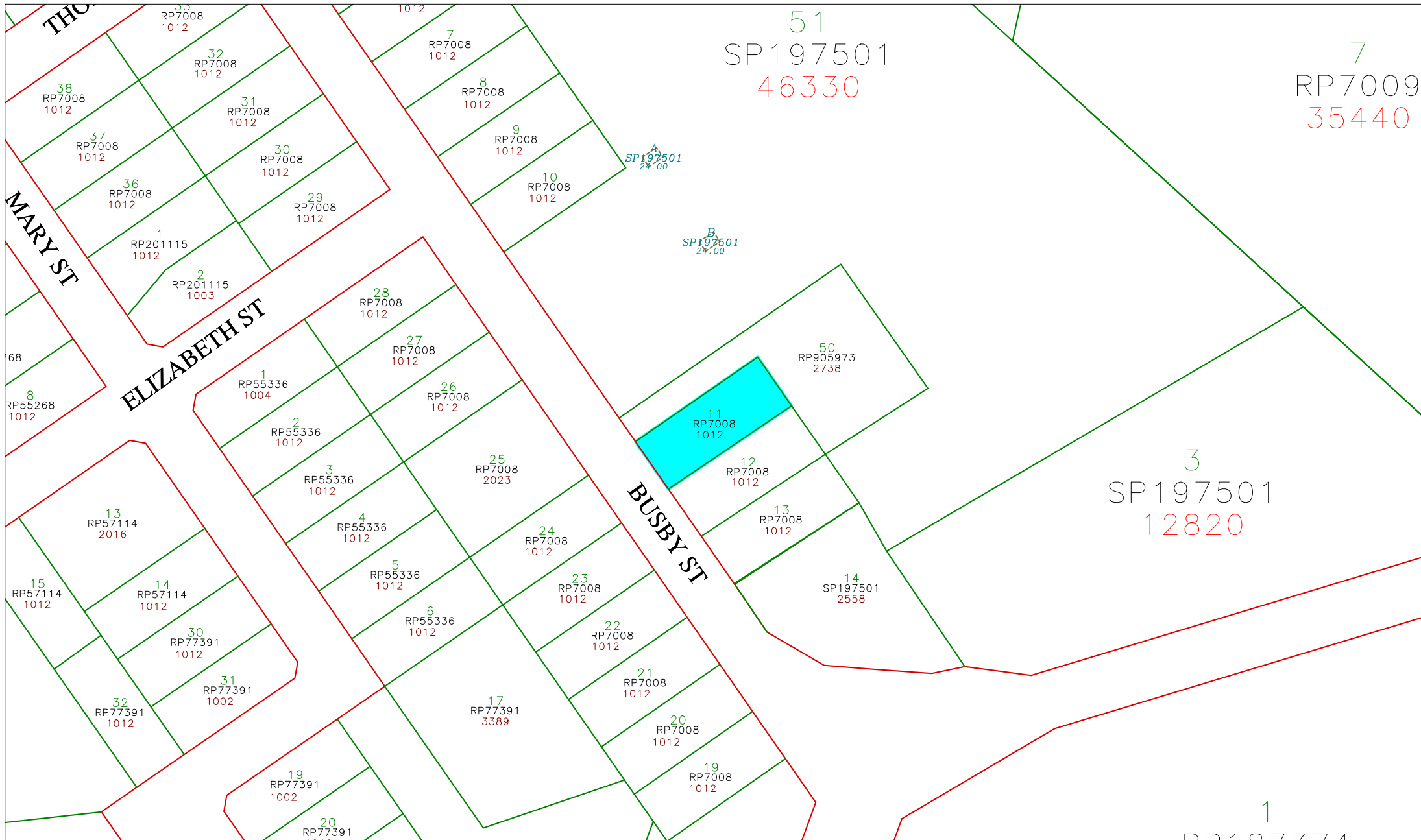

-  Easement
-  Road
-  Lot Boundary
-  Property Polygons
-  Railway

Map 14 - Amamoor Hall

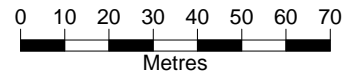

Scale: 1:1708.206



GYMPIE REGIONAL COUNCIL
 Copyright © The State of Queensland
 (Department of Lands) 1994

Please note that the accuracy of the information hereon is not guaranteed. The information is indicative only and is meant only as a guide. You should therefore undertake your own site inspection and survey to provide the information you are seeking. No liability is accepted by the Council for any error or omission or loss incurred by reliance being placed on the information contained on this plan and/or search.

Date: 10/12/2008
 Time: 9:44

DD 1 0 7 7 4