



AMAMOOR STATE SCHOOL

2 Elizabeth Rd, Amamoor

Place Details

PROPERTY DESCRIPTION:	2 on CP849465
PLACE NAME:	Amamoor State School
ORIGINAL USE:	Education
DATE OF CONSTRUCTION:	1921
AREA (m ²):	63950.00m ²
ASSESSMENT NUMBER:	5227
PARCEL NUMBER:	14185
OWNER:	State of Queensland
HERITAGE SIGNIFICANCE:	Local
CULTURAL SIGNIFICANCE:	Historical, Social



Photo sourced from Mark Baker Town Planning Consultants Pty Ltd in association with Ivan Mc Donald Architects

Historical Data

Amamoor State School is an example of an original Queensland school building. The building was initially located at Bollier before being relocated to its current site in 1950. From then on the building became a teacher's residence before an additional classroom was built in 1959.

Place Assessment

Unknown

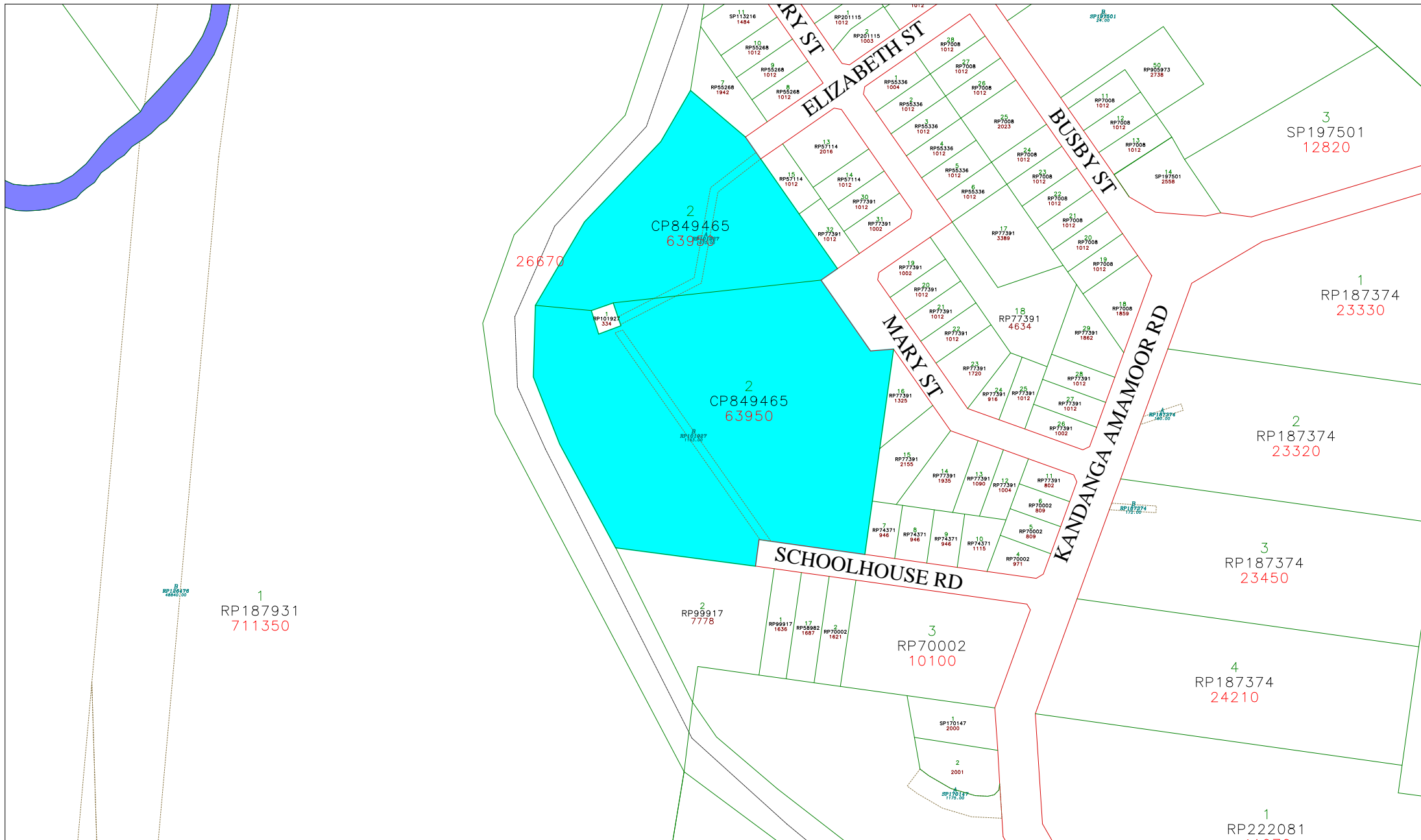

- Easement
- Road
- Property Polygons
- Lot Boundary
- Railway
- Water Body

Map 43 - Amamoor State School

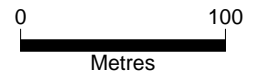

Scale: 1:3689.029



GYMPIE REGIONAL COUNCIL
 Copyright © The State of Queensland
 (Department of Lands) 1994

Please note that the accuracy of the information hereon is not guaranteed. The information is indicative only and is meant only as a guide. You should therefore undertake your own site inspection and survey to provide the information you are seeking. No liability is accepted by the Council for any error or omission or loss incurred by reliance being placed on the information contained on this plan and/or search.

Date: 5/12/2008
 Time: 16:20