



WATERWORKS PUMP HOUSE

Waterworks Rd, Jones Hill

Place Details

PROPERTY DESCRIPTION:	224 on SP175079
PLACE NAME:	Waterworks Pump House
ORIGINAL USE:	Public Utilities
DATE OF CONSTRUCTION:	1900
AREA (m ²):	389400.00m ²
ASSESSMENT NUMBER:	7977
PARCEL NUMBER:	23460
OWNER:	Gympie Regional Council
HERITAGE SIGNIFICANCE:	Local
CULTURAL SIGNIFICANCE:	Historical



Photo sourced from Mark Baker Town Planning Consultants Pty Ltd in association with Ivan Mc Donald Architects

Historical Data

Unknown

Place Assessment

Water reticulation commenced in 1900.

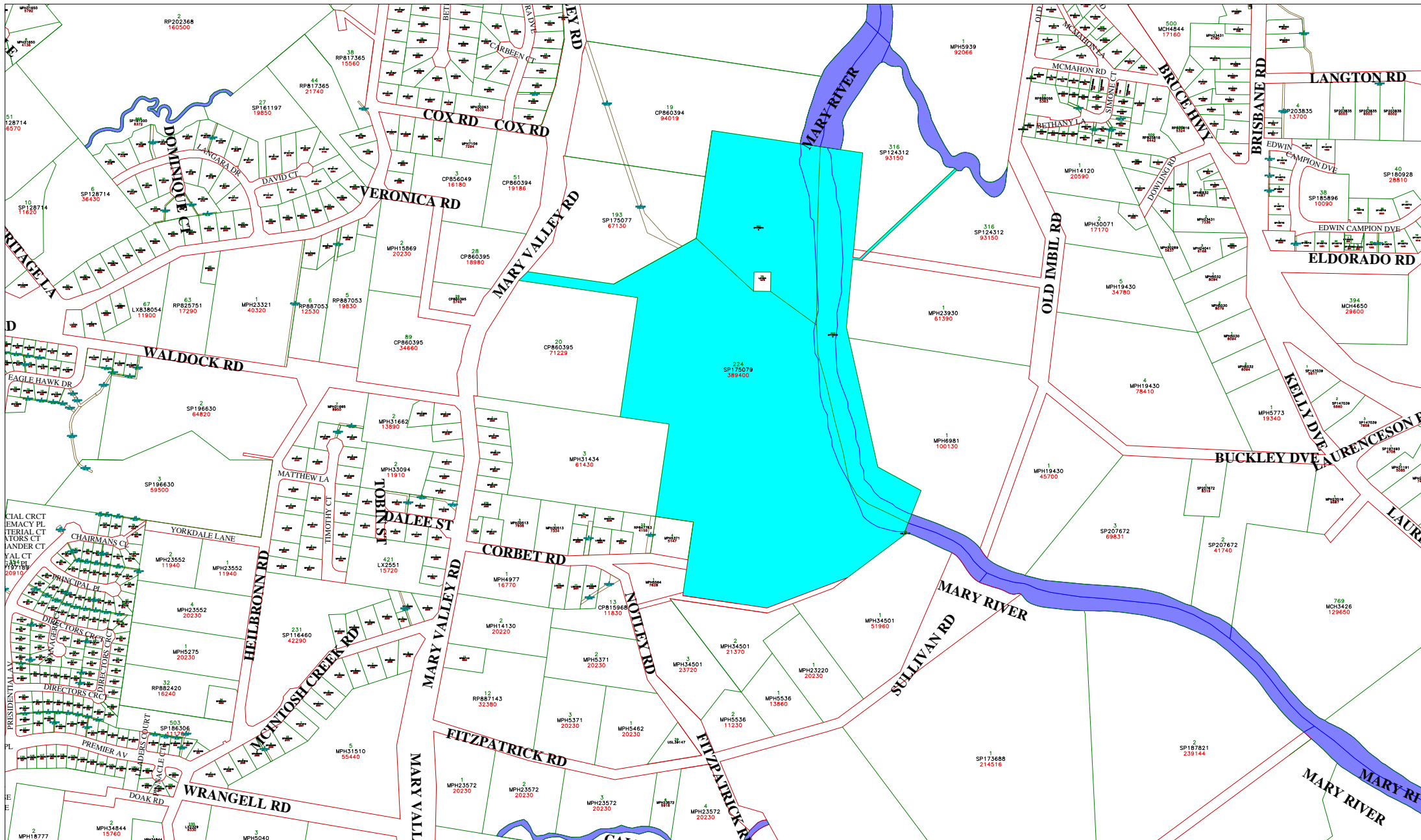

- Easement
- Road
- Property Polygons
- Lot Boundary
- Railway
- Stream
- Water Body

Map 97 - Waterworks Pump House

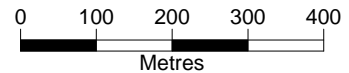

Scale: 1:9968.377

GYMPIE REGIONAL COUNCIL
 Copyright © The State of Queensland
 (Department of Lands) 1994

Please note that the accuracy of the information hereon is not guaranteed. The information is indicative only and is meant only as a guide. You should therefore undertake your own site inspection and survey to provide the information you are seeking. No liability is accepted by the Council for any error or omission or loss incurred by reliance being placed on the information contained on this plan and/or search.



Date: 8/12/2008
 Time: 12:18