



## KANDANGA COTTAGE

65 Main St, Kandanga

### Place Details

PROPERTY DESCRIPTION:	2 on SP128937
PLACE NAME:	Kandanga Cottage
ORIGINAL USE:	Commercial Premise
DATE OF CONSTRUCTION:	Unknown
AREA (m <sup>2</sup> ):	1507.00m <sup>2</sup>
ASSESSMENT NUMBER:	5626
PARCEL NUMBER:	14785
HERITAGE SIGNIFICANCE:	Local
CULTURAL SIGNIFICANCE:	Historical



Photo sourced from Mark Baker Town Planning Consultants Pty Ltd in association with Ivan Mc Donald Architects

### Historical Data

Unknown

### Place Assessment

Unknown

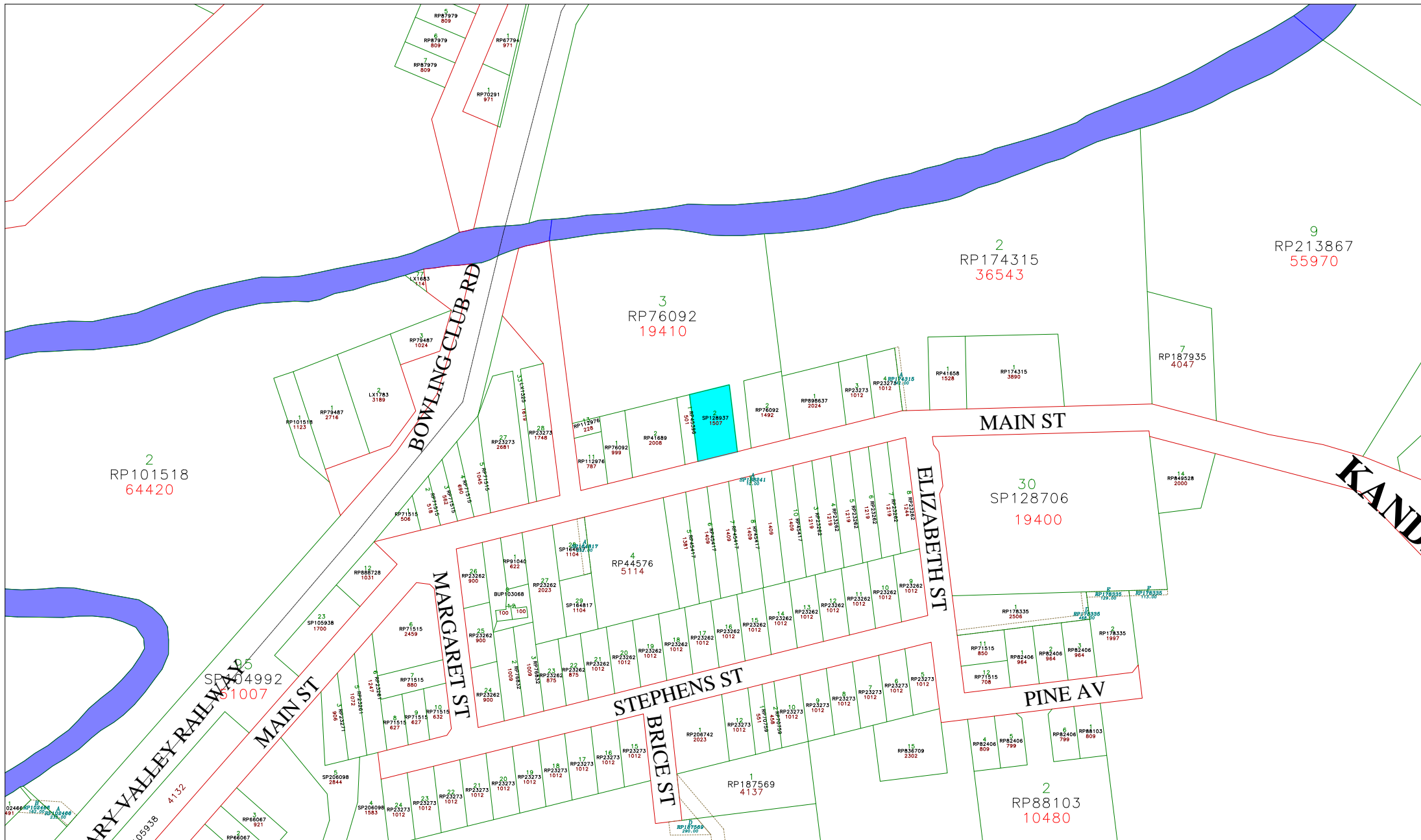

- Easement
- Property Polygons
- Road
- Lot Boundary
- Railway

Map 68 - Kandanga Cottage



Scale: 1:3690.899

**GYMPIE REGIONAL COUNCIL**  
 Copyright © The State of Queensland  
 (Department of Lands) 1994

Please note that the accuracy of the information hereon is not guaranteed. The information is indicative only and is meant only as a guide. You should therefore undertake your own site inspection and survey to provide the information you are seeking. No liability is accepted by the Council for any error or omission or loss incurred by reliance being placed on the information contained on this plan and/or search.



Date: 8/12/2008  
 Time: 10:42