



MONKLAND RAILWAY STATION

Brisbane Rd, Monkland

Place Details

PROPERTY DESCRIPTION:	444 on SP105941
PLACE NAME:	Monkland Railway Station
ORIGINAL USE:	Transportation
DATE OF CONSTRUCTION:	Unknown
AREA (m ²):	6561.00m ²
ASSESSMENT NUMBER:	19601
PARCEL NUMBER:	22509
OWNER:	Queensland Rail
HERITAGE SIGNIFICANCE:	Local
CULTURAL SIGNIFICANCE:	Historical



Photo sourced from Mark Baker Town Planning Consultants Pty Ltd in association with Ivan Mc Donald Architects

Historical Data

Unknown

Place Assessment

Unknown

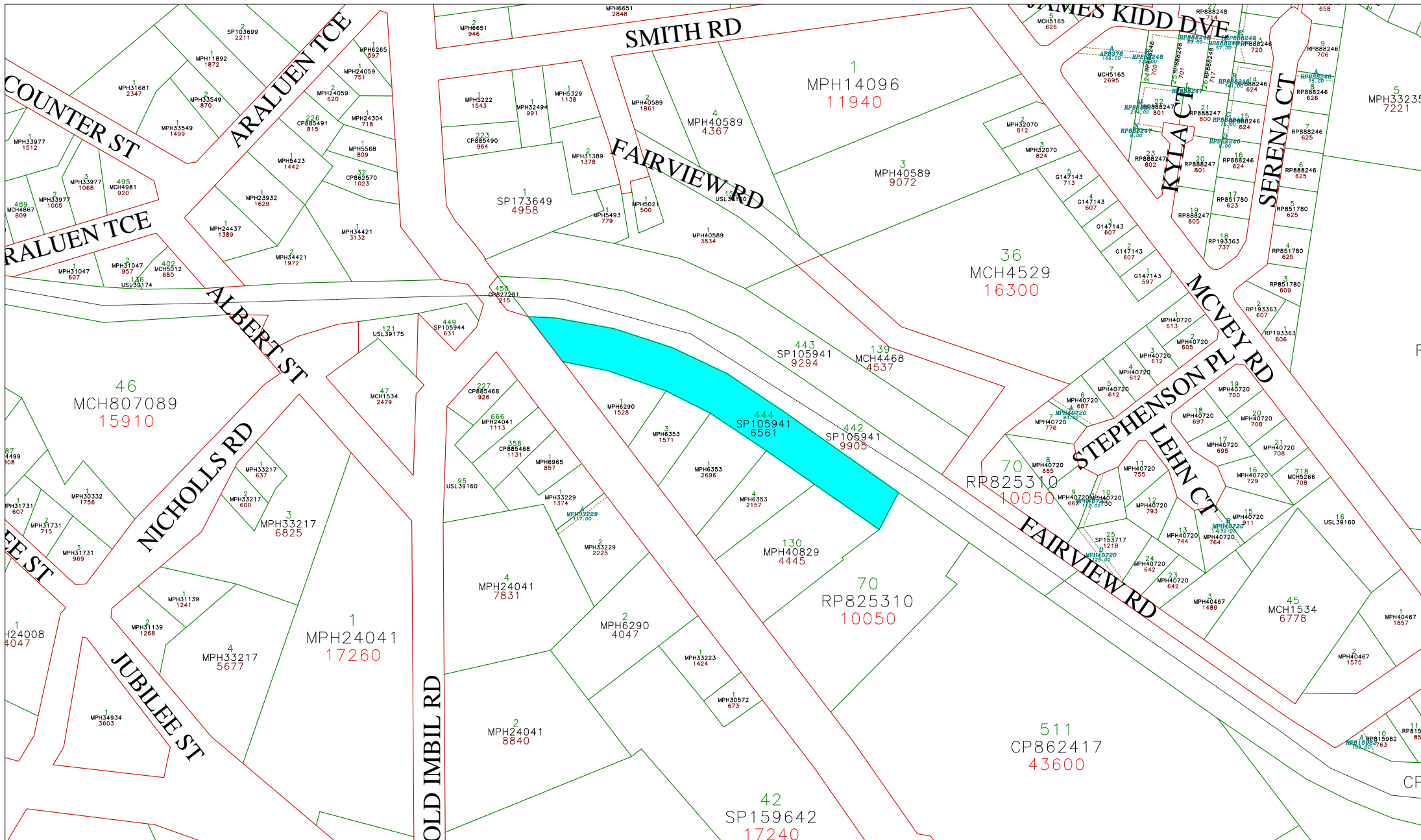

- Easement
- Road
- Lot Boundary
- Property Polygons
- Railway

Map 05 - Monkland Railway Station



Scale: 1:3151.826

GYMPIE REGIONAL COUNCIL
 Copyright © The State of Queensland
 (Department of Lands) 1994

Please note that the accuracy of the information hereon is not guaranteed. The information is indicative only and is meant only as a guide. You should therefore undertake your own site inspection and survey to provide the information you are seeking. No liability is accepted by the Council for any error or omission or loss incurred by reliance being placed on the information contained on this plan and/or search.



Date: 5/12/2008
 Time: 9:30