



1 FERGUSON STREET, GYMPIE

1 Ferguson St, Gympie

Place Details

PROPERTY DESCRIPTION:	2 on MPH23983
PLACE NAME:	1 Ferguson St
ORIGINAL USE:	Residential Premises
DATE OF CONSTRUCTION:	1950's
AREA (m ²):	989.00m ²
ASSESSMENT NUMBER:	2584
PARCEL NUMBER:	10873
HERITAGE SIGNIFICANCE:	Local
CULTURAL SIGNIFICANCE:	Historical, Architectural



Photo sourced from Mark Baker Town Planning
Consultants Pty Ltd in association with
Ivan Mc Donald Architects

Historical Data

Unknown

Place Assessment

This house is a rare example of a 1950's era timber house with modernist features. The front fence is also styled to complement the house.

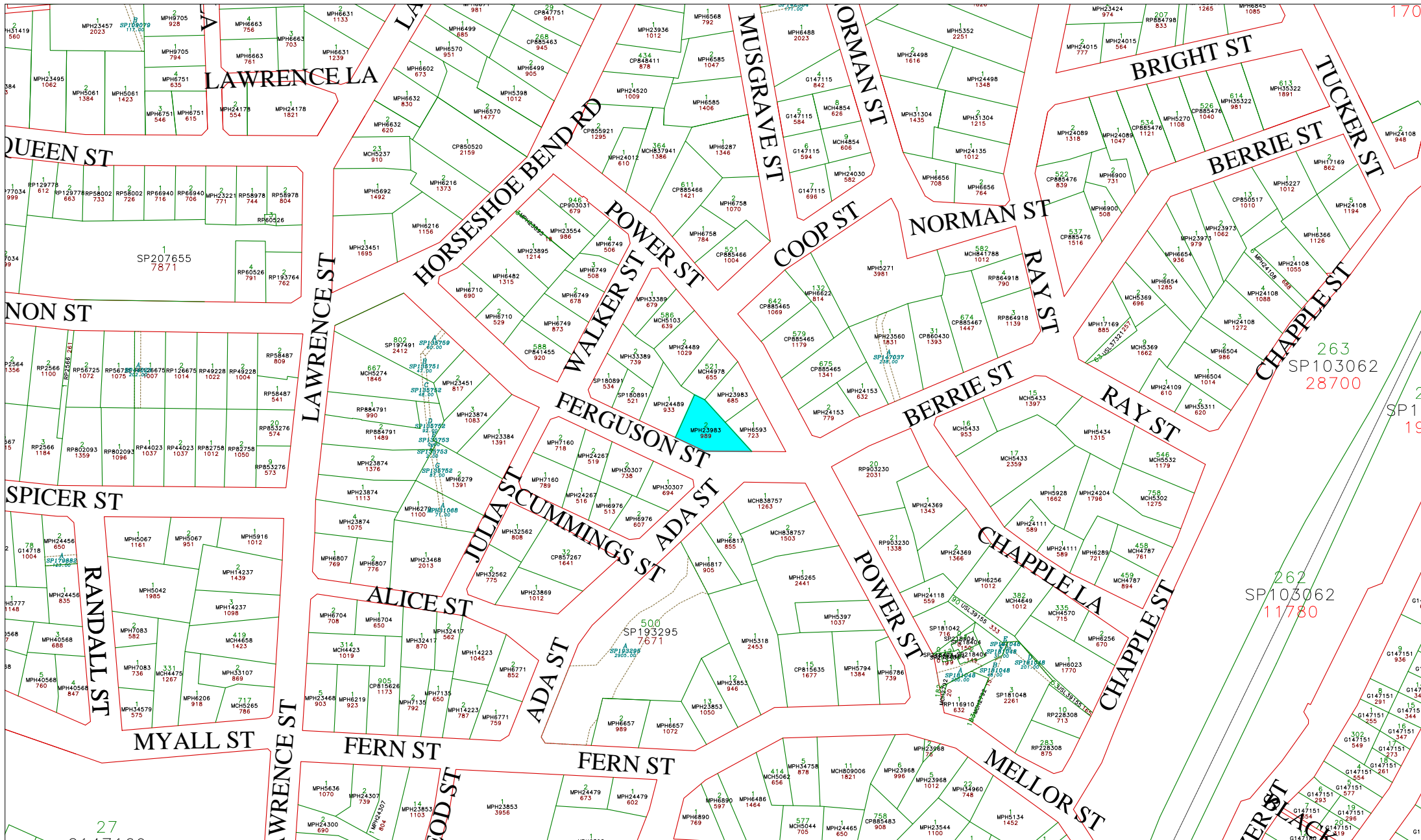

- Easement
- Road
- Lot Boundary
- Property Polygons
- Railway

Map 47 - 1 Ferguson Street

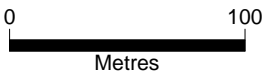

Scale: 1:3209.577

GYMPIE REGIONAL COUNCIL
 Copyright © The State of Queensland
 (Department of Lands) 1994

Please note that the accuracy of the information herein is not guaranteed. The information is indicative only and is meant only as a guide. You should therefore undertake your own site inspection and survey to provide the information you are seeking. No liability is accepted by the Council for any error or omission or loss incurred by reliance being placed on the information contained on this plan and/or search.



Date: 5/12/2008
 Time: 16:28