



## FORMER NASHVILLE POLICE STATION

9 Graham St, Gympie

### Place Details

|                         |                             |
|-------------------------|-----------------------------|
| PROPERTY DESCRIPTION:   | 3 on G14783                 |
| PLACE NAME:             | 9 Graham St                 |
| ORIGINAL USE:           | Public Services and Defence |
| DATE OF CONSTRUCTION:   | Unknown                     |
| AREA (m <sup>2</sup> ): | 1181.00m <sup>2</sup>       |
| ASSESSMENT NUMBER:      | 3558                        |
| PARCEL NUMBER:          | 12046                       |
| OWNER:                  | Queensland Police Service   |
| HERITAGE SIGNIFICANCE:  | Local                       |
| CULTURAL SIGNIFICANCE:  | Historical                  |



Photo sourced from Mark Baker Town Planning  
Consultants Pty Ltd in association with  
Ivan Mc Donald Architects

### Historical Data

Unknown

### Place Assessment

The building is regarded as a significant former local police station.

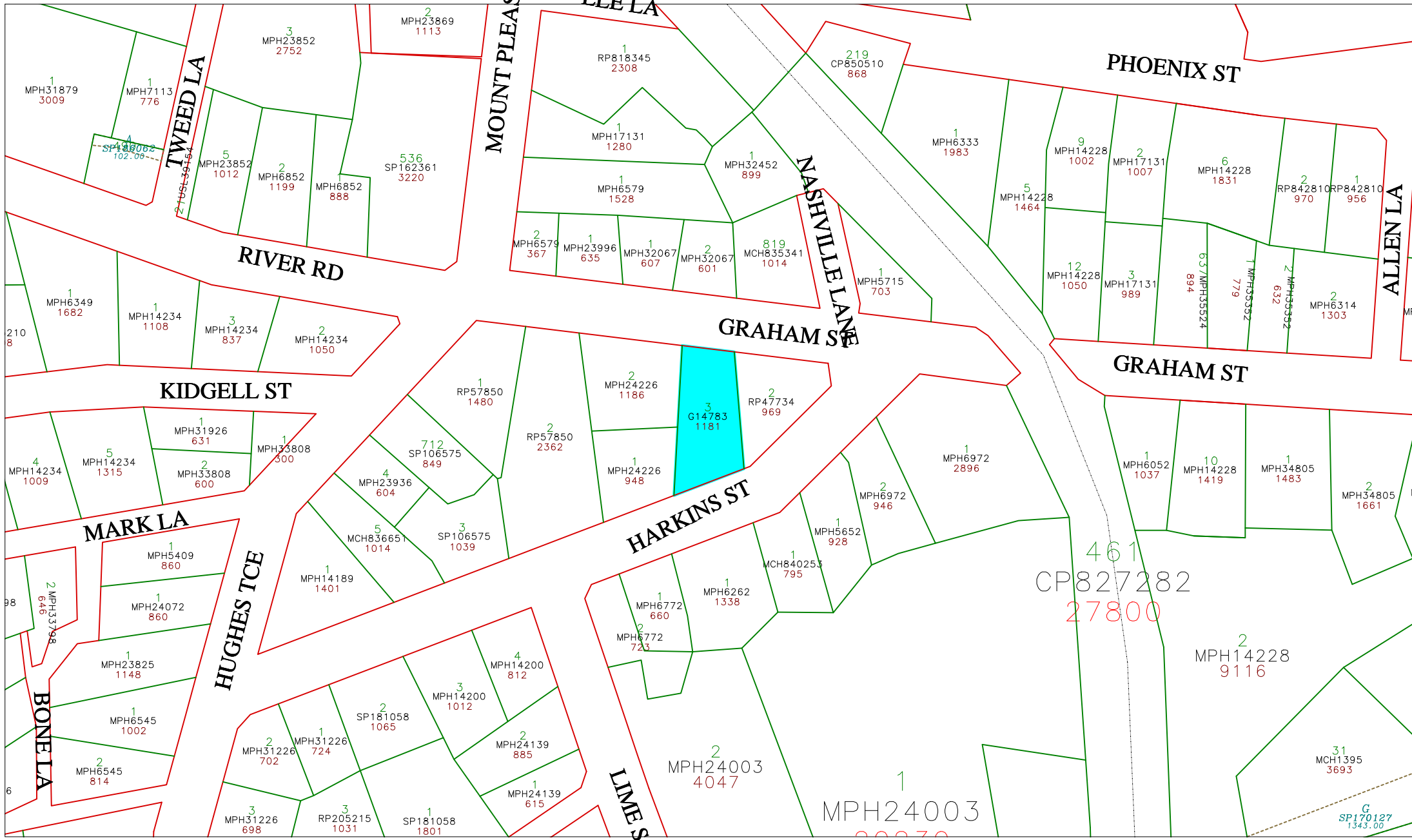

- Easement
- Road
- Property Polygons
- Lot Boundary
- Railway
- Water Body

**Map 51 - Former Nashville  
Police Station**

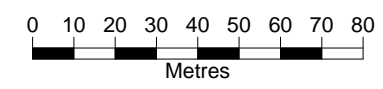

Scale: 1:1829.246

**GYMPIE REGIONAL COUNCIL**  
Copyright © The State of Queensland  
(Department of Lands) 1994

Please note that the accuracy of the information hereon is not guaranteed. The information is indicative only and is meant only as a guide. You should therefore undertake your own site inspection and survey to provide the information you are seeking. No liability is accepted by the Council for any error or omission or loss incurred by reliance being placed on the information contained on this plan and/or search.



Date: 5/12/2008  
Time: 16:35