

New Bayswater Station Public Art

Eight Perth-based artists are creating public art for the new Bayswater Station. Each artist brings a diverse background, experience and style to capture Bayswater history and culture through a range of mediums.

Delivered under the METRONET Public Art Strategy, each piece aims to celebrate Bayswater's distinct identity, making enjoyable areas for local communities while supporting opportunities for emerging and established artists.

The new Bayswater Station will be a key connection point for public transport services in Perth's north-east, offering more travel choices to Perth Airport, the Swan Valley region, Perth's central business district and beyond.



Leake Street underpass mural – Emily Jackson



Entry statement mural – Andrew Frazer and Jade Dolman



Botanical murals (detail) along noise walls – Joanna Brown

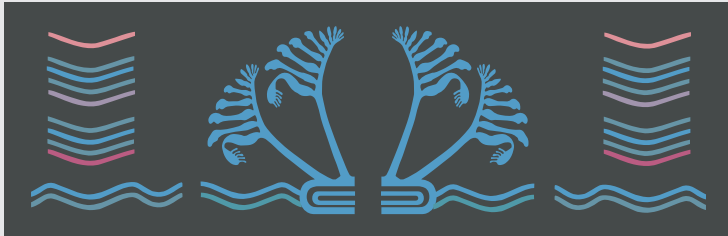

Functional sculpture – Peter Farmer in collaboration with Miranda Farmer and Jason Hirst

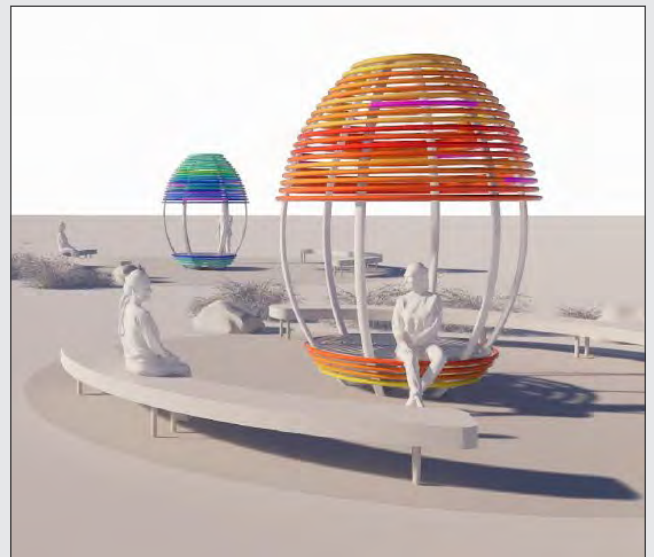

Concepts only

Station platform artwork – Nathanael Whale

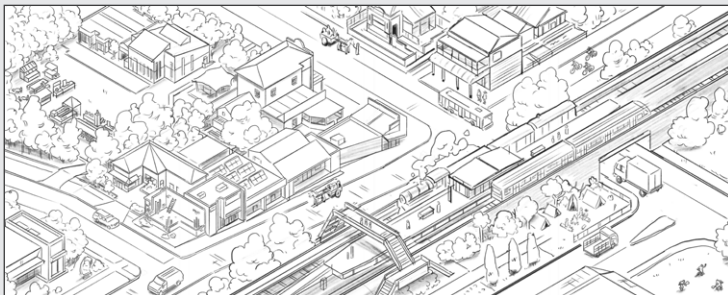

The METRONET Noongar Reference Group provides input, advice and support for Noongar cultural recognition and cultural input into place making across all METRONET projects, and has endorsed the Noongar-led art pieces for this project.

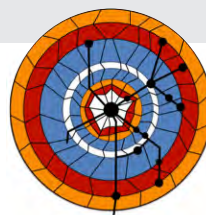

The Noongar place name for the Bayswater area is *Biraliny* and the narrative is 'The track where the Merenj (food plants) is located'.

MORE INFORMATION

9326 3666

metronet.wa.gov.au

info@metronet.wa.gov.au

@metronetperth

New Bayswater Station Public Art



Infrastructure details modified on map to enable public art locations to be highlighted

1

Functional sculpture

Noongar artist Peter Farmer, in collaboration with Miranda Farmer and Jason Hirst, will create two functional seating sculptures, *Kaarl and Kiep* (fire and water), for the station forecourt outside the main entrance. The pieces will create a strong statement and provide colour and light to the forecourt.

2

Leake Street underpass mural

A mural of flora and fauna local to the Bayswater area will shine brightly in the Leake Street pedestrian underpass. Emily Jackson's work will bring colour and vibrancy to the underpass, applying the work on the walls, ceilings, and area around the underpass.

3

Entry statement mural

Andrew Frazer will create bright, vibrant murals in a number of locations around Bayswater Station. The artwork features the Noongar place name for Bayswater, *Biraliny*, and is brought to life through Andrew's signature typography and textured style. Emerging Noongar artist Jade Dolman is working with Andrew to develop the patterns and design. The bright colours will mark the entry to the station, and will carry through to the rest of the station.

4

Station platform artwork

Nathanael Whale's work will showcase the two sides of Bayswater – the town centre and the river. Displayed on each of the station platforms, this detailed graphic of Bayswater's rich history will engage passengers as they wait for the train.

5

Botanical noise wall mural

In sections, a total of 160 metres of vibrant flora and fauna will bring a splash of colour to the noise walls. Joanna Brown will work closely with her design team to contribute to the sense of arrival to the new Bayswater Station.

6

Integrated artwork and poetry

Local writer Nandi Chinna will create a written piece to feature in the landscape 'ribbon element' surrounding the station, complemented by imagery provided by emerging Noongar artist Jade Dolman. Nandi's artwork will reflect the local community culture and history, incorporating elements from poetry workshops completed at local schools and providing an educational opportunity by featuring poetry in language.

7

Commemorative bridge artwork (digital and sound)

Leon Ewing has created an audio-visual concept to honour the iconic 'old Baysie Bridge' and its history within the Bayswater and Perth communities. Using a low clearance LED screen and audio recordings taken from the bridge, the artwork will keep the bridge's 'reign of terror' alive by tallying virtual truck strikes from the height of the old bridge.

8

Morley-Ellenbrook Line noise wall mural

Artist to be commissioned to create a mural spanning across the retaining and noise walls to create a rich and vibrant backdrop to Railway Parade.