

**Bear  
Delta-V™**

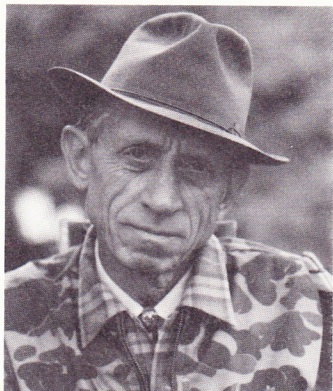

## **IMPORTANT**

Instruction Booklet And Warranty For  
This Bear Delta-V™ Enclosed. Please  
Leave On Bow Until Time Of Purchase.



# Congratulations

on your purchase of a New Bear Delta-V™. You have made an excellent choice and now own the most advanced bow available. A few minutes spent reading over this instruction booklet will aid you in getting the most out of your new bow.

*Fred Bear*

## A FEW COMMON SENSE RULES OF ARCHERY SAFETY

- Shoot only at the target.
- Never shoot up in the air or in any direction where you may destroy property or endanger life.
- Always be sure that the area back of your target is clear.
- Never allow anyone to retrieve arrows until all arrows have been shot.
- Be sure arrows are of the correct length and stiffness for your bow.
- Check your arrows after every shot. If an arrow has even a small crack, break it and throw it away immediately.
- Your Bear Delta-V is an extremely high performance bow—treat it with respect!



## How To Care For Your Bear Delta-V™

This precision bow is extremely well built and with proper care should give you many years of good use. Common sense, proper maintenance and a few rules will aid you in keeping your bow in top shape.

1. Keep your bow dry at all times. If it gets wet while hunting, wipe it as dry as possible and store uncovered.
2. As needed lubricate axles, pulleys and cams with a spray of WD-40 or a few drops of light machine oil. Take care not to spray the cable adjusters, as friction is important to their operation.
3. Do not draw your Delta-V without speed/draw check blocks.
4. The Delta-V is high stressed for optimum performance. Carefully check the bow string and cables each time you use the bow. Replace at the first signs of wear.
5. Never dry fire your Delta-V; that is, never release the string without an arrow in place.
6. Do not attempt to draw your bow beyond its maximum draw length. If you do, damage could result.
7. Do not drop your bow, do not lean on it or put the ends of the limbs on the ground.

---

**NOTE:** Your Bear Delta-V is a high performance bow in the truest sense of the word. It is designed to be at the leading edge of today's technology and many of the parts are highly stressed. It should be noted that great care should be taken when disassembling this bow, to prevent damage or possible personal injury. If you are not mechanically inclined, or you would rather have somebody else work on your bow, take it to your local Bear Archery Warranty Service Center.

**NOTE:** Due to the high performance nature of this bow, bowstrings, cables and string stops will periodically have to be replaced. Watch carefully for fraying or signs of wear and replace parts as required. String and power cables should be replaced at about 4,000-5,000 shots, bowstring and string stops as needed. Timing cables should be replaced when broken strands appear.

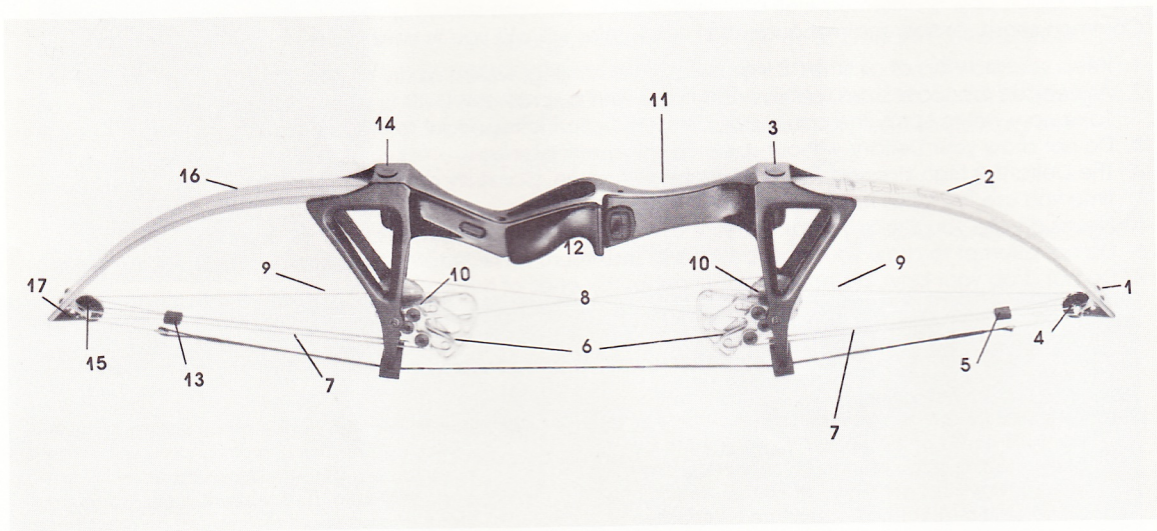



## Delta-V™ Terminology

Parts may be purchased through your Authorized Bear Archery Service Centers. Give them the part number, quantity required and the **serial** number of the bow.

1. Stainless Steel Tip Yoke
2. Super Bearglas™ Limb (upper)
3. Limb Adjustment Bolt
4. Tip Wheel Assembly
5. Cable Cage
6. Programmed Cams
7. Power Cables
8. Timing Cable
9. String Cables
10. Interchangeable Speed/Draw Length Blocks
11. Magnesium Handle with Power Grip Design.
12. Interchangeable Grip
13. Cable Cage
14. Limb Adjustment Bolt
15. Tip Wheel Assembly
16. Super Bearglas™ Limb (lower)
17. Stainless Steel Tip Yoke

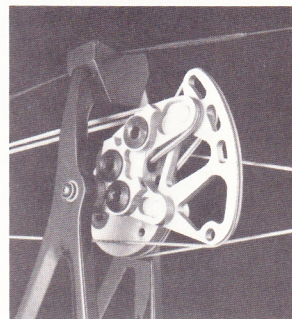
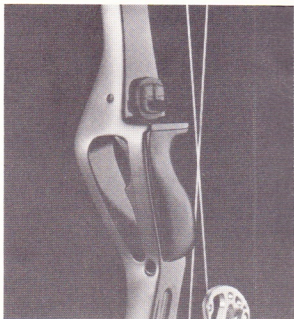

## How To Change Draw Length On Your Bear Delta-V™

Your Bear Delta-V is capable of draw lengths from 25" to 33". Full draw is determined by the color coded speed/draw length blocks. While an archer with a 28" draw can shoot the bow set for a 32" draw length he or she will not achieve full let-off or maximum performance.

The process of changing draw length is simple. Using a 3/32" Allen Wrench remove the set currently on the bow and replace with a pair of the required draw length. This can be done without the use of a bow compressor and with the bow fully strung.

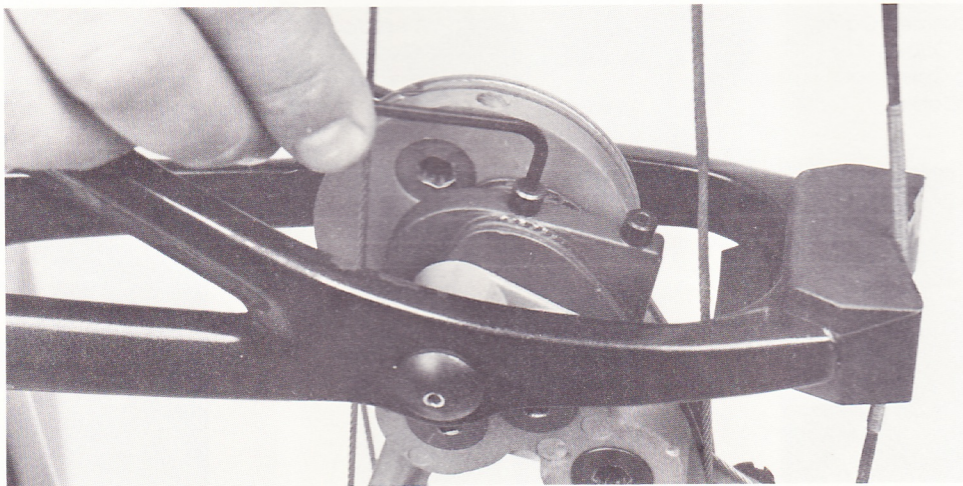

Various speed/draw length blocks are available at your local Bear Archery dealer. They are available from 25" to 33" draw, in one inch increments.

**NOTE:** Do not draw your Delta-V without speed/draw length blocks in place.



## How To Use A Delta-V™ Bow Compressor

NOTE: Due to the high performance nature of this bow, many parts are under a great deal of tension. Use care to avoid the possibility of injury to yourself or damage to the bow. If you are not mechanically inclined, take the bow to the nearest Bear Archery Service Center for service. There is a complete listing of Centers in the rear of this booklet.

To work on the bow yourself, you will require a Delta-V Bow Compressor. The procedure for use is as follows:

1. Remove the interchangeable grip from the bow and lay the Delta-V on a clean table or work area, sight window up and bowstring towards you.
2. Slide the legs of the bow compressor over the bowstring and grip area (but not around the timing cables), positioning the legs so that two bolt locations go past the grip area.
3. Install a bolt and nut finger tight in the set of holes on the bowstring side of the grip.
4. Install a bolt and nut finger tight in the hole nearest the handle on the far side of the grip.

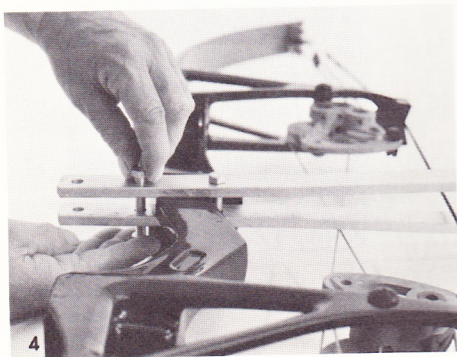

5. Straighten and loop the bow compressor webbing around the entire length of the bow, fitting the webbing on the inside of the compressor legs. Turn the web on edge so it can fit into the narrow gap.
6. Install the remaining nut and bolt finger tight in the last set of holes in the compressor legs, trapping the webbing between two sets of bolts.
7. Make sure that the compressor is perpendicular to the bow handle and that the webbing is centered on the limbs. Begin drawing up the webbing with the nut bar and continue to do so until tension is released from the cables. Keep constant watch on the webbing to make sure that it is properly centered on the limbs as you draw it up.

**NOTE:** Great care must be observed to make sure that the webbing is centered and remains in place when the compressor puts tension on the bow, otherwise damage could result to the bow or possible injury to you.

8. Repair or replace bow parts as required. Release of tension on the bow is a reverse of the above seven steps.
9. Retune the bow.

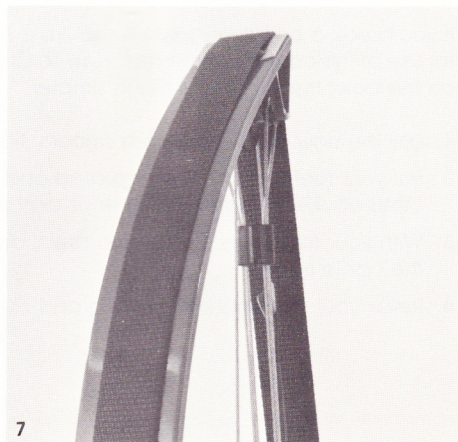
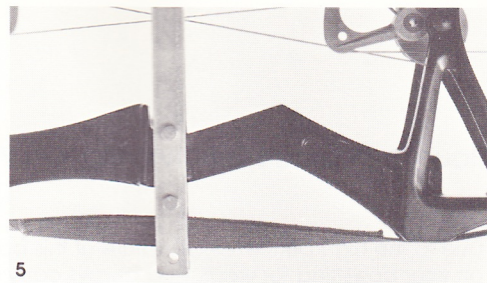

## How To Replace a Bowstring On Your Bear Delta-V™

Due to the high performance nature of this bow, strings will have a relatively short life. Keep close watch on your bowstring for wear, and always carry a spare bowstring with nocking point and accessories attached.

If you break a bowstring you will require a Delta-V bow compressor to reassemble the bow. See instructions for use of this compressor under "How To Change A Cable Or Major Part". To replace a worn or frayed string on the bow, the process is much simpler.

1. Lay the bow on its back on a smooth, flat surface. Fit one end of the new bowstring over the cable end.
2. Put your foot firmly on the grip area and pull the bowstring towards you. Slip the new bowstring over the other double-headed cable ends and relax your pull on the bowstring.
3. With your foot firmly on the grip area, draw the new bowstring towards you. Take the old bowstring off the cable ends.
4. Relax your pull on the bowstring and check the bow over before shooting.



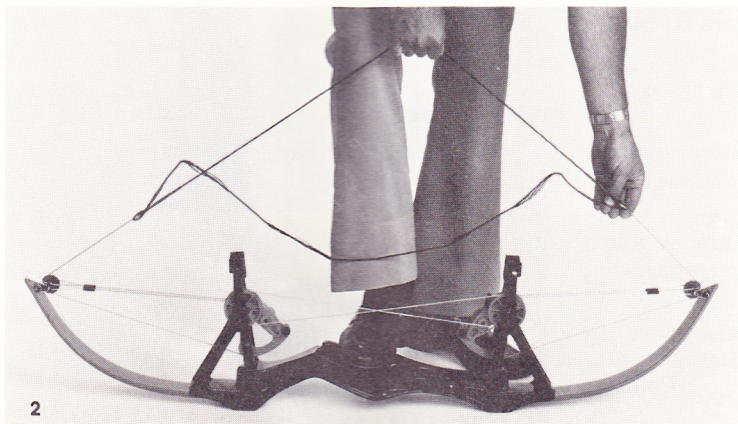
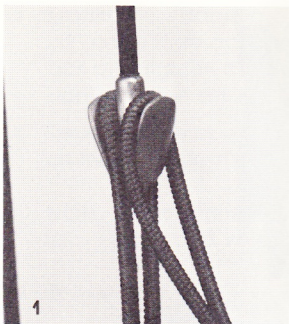

## How To Replace String Cables On Your Bear Delta-V™

The two string cables on the Bear Delta-V should be replaced after every 4,000-5,000 shots or when they show wear. Replace both cables at the same time. Replacement requires the use of a Delta-V Bow Compressor. The procedure is as follows:

1. Compress the bow using the instructions on "How To Use A Delta-V Bow Compressor".
2. Remove bowstring, first noting the path that all of the cables follow.
3. Using a 3/32" Allen Wrench loosen the set screw from one of the string cable adjusters six full turns.
4. Using a 1/4" Allen Wrench turn the adjuster counterclockwise and unwind cable fully. Wiggle the Allen Wrench from side to side and remove the adjuster upwards.
5. Remove cable from cam and note travel path around cam and tip wheel for reassembly.
6. Unwind cable around tip wheel and remove.

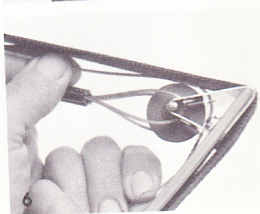
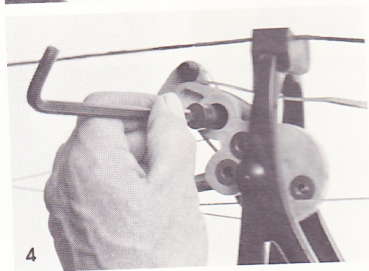
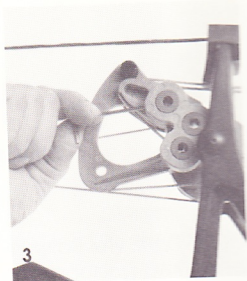

- Rewind new cable around tip wheel and thread into cam. Slide adjuster over the end of cable bail and tighten adjuster 1/2 turn clockwise. Lightly tighten set screw.
- Repeat same operation to replace string cable on the other cam.

**NOTE:** Overtightening set screw will distort the cam and void your warranty.

- Retune Bow.

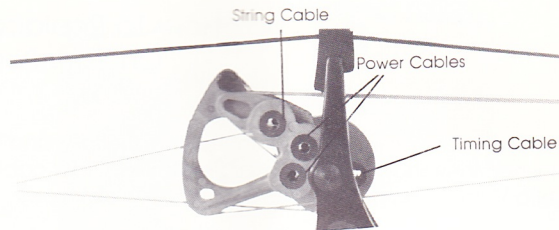



## How To Replace Power Cables On Your Bear Delta-V™

There are four power cables on the Bear Delta-V and they should all be replaced after every 5,000 shots or when they show signs of wear. Replace all four cables at the same time. Replacement requires use of a Delta-V Bow Compressor. The Procedure is as follows:

1. Compress the bow using the instructions in "How To Use A Delta-V Bow Compressor".
2. Remove and replace only one cable at a time.
3. Using a 3/32" Allen Wrench loosen the set screw on one of the adjusters 6 full turns.
4. Remove cable retaining cap-nut.  
Turn adjuster counterclockwise using a 1/4" Allen Wrench to unwind cable. Wiggle Allen Wrench from side to side and remove the adjuster from the cam upwards.
5. Remove cable from cam and unthread through cable cage and around tip axle spool.
6. Thread new cable along the same path.

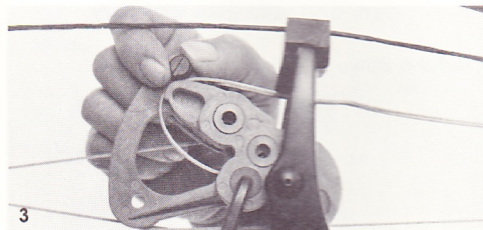

7. Fit cable ends into the cam (one ball at a time because of the restricted entry) and slip the cable adjuster over the cable ball ends. Replace cable retaining cap-nut. Check cable path and make sure it is not twisted, except for the  $\frac{1}{4}$  twist the side by side strands take between the cable cage and the tip axle.
8. Turn cable adjuster  $\frac{1}{2}$  turn clockwise and lightly snug up the Allen setscrew.

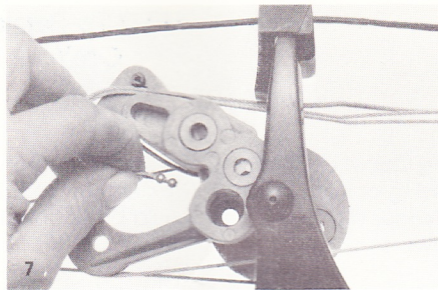

**NOTE:** Overtightening set screw will distort the cam and void your warranty.

9. Follow the same procedure for replacing the other cable on the same cam and then progress to changing the cables on the other cam in the same manner as above.
10. Retune the bow.

## How To Replace Timing Cables On Your Bear Delta-V™

The Timing Cable on The Delta-V is long-lasting and should be replaced after 25,000 shots or when it shows fraying or signs of wear. Replacement requires use of a Delta-V Bow Compressor. NOTE: The Timing Cable is under high stress and should be handled carefully. The procedure for replacement of the cable is as follows:

1. Compress the bow using the instructions on "How To Use A Delta-V Bow Compressor".
2. Loosen the set screws on the timing cable adjusters on both cams using a 3/32" Allen Wrench. Make sure to loosen them at least six full turns.
3. Turn the adjusters on both cams counterclockwise to loosen the cable.

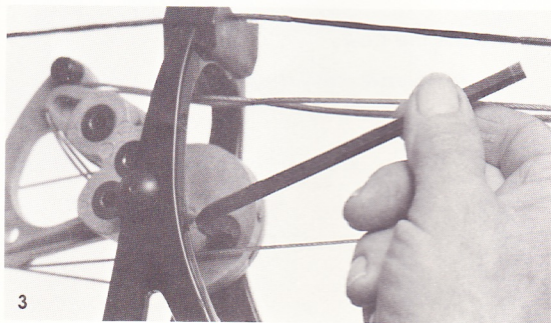

4. With the adjuster slot in alignment with the cable hole—remove the cable adjusters by wiggling the Allen Wrench from side to side and moving the adjuster upwards.
5. Remove the timing cable, carefully noting the travel path around the cams.
6. Replace and rethread using the new cable.
7. Fit the cable end into the cam and slide cable adjuster over the end of the cable ball. Tighten adjuster 1/2 turn clockwise and lightly tighten set screw.
8. Fit the other cable end into the other cam and repeat instruction number seven.
9. Retune bow.

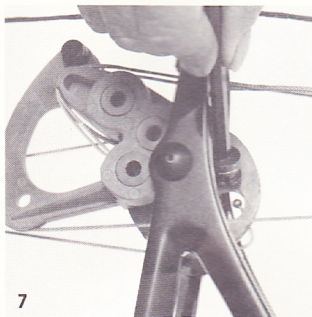



## How To Check The Tune Of Your Bear Delta-V™

The Delta-V is tuned at the factory and remains in tune unless a major change is made in the bow. To check tuning, do the following:

1. Measure the distance from the tip of the cam to the bowstring. It should be the same on both cams; if it is not, the timing cable will need adjustment.
2. Check adjustment of both string cables. Make sure that the cables overlay the marks on the cams. If they do not, the string cables will need adjustment.
3. Lay a long straight edge over the centerline of the cam axles and the tip axles. The edges of the tip wheel axles should lay tangent or slightly toward the string line. If they do not, the power cables will need adjustment.
4. Using the bowstring for a centerline, make sure that the cable cage is bisected by the bowstring. If not, the power cables will need adjustment.

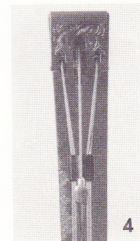
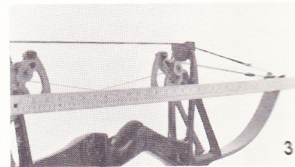
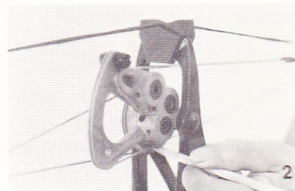

## How To Tune Your Delta-V™ Timing Cable

1. Using a Delta-V Bow Compressor, put light tension on the bow. The Compressor is used here as a safety factor primarily to keep the bow together if you lose tension on your wrench while adjusting.
2. The idea to adjusting the timing cables is to tighten or loosen the cables until the tips of both cams measure the same distance from the bowstring. It may be necessary to make several slight adjustments to both cam timing adjusters. The timing cables should be adjusted so they do not sag at all.
3. To adjust, loosen one of the cable adjuster set screws and tighten or loosen the cable with a ¼" allen wrench, keeping tension on the cable until you retighten the set screw.

**NOTE:** Do Not Have Both Cams Loose At The Same Time.  
Do Not Overstress The Cables.

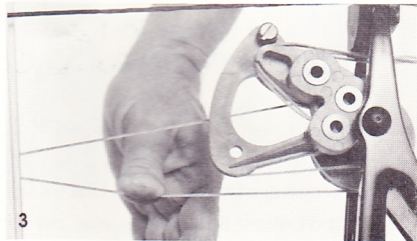
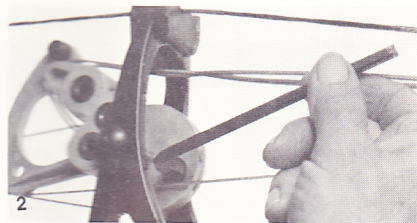
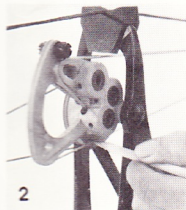

## How To Tune Your Delta-V™ String Cables

1. Using a Delta-V Bow Compressor, put light tension on the bow.
2. On the out-of-adjustment cam, loosen the string cable timing adjuster set screw six full turns using a 3/32" allen wrench. Using a ¼" allen wrench tighten or loosen the cable adjuster until the cable overlays the mark on the cam.

3. Tighten the set screw, loosen the compressor and re-check both cable positions on the cams.
4. Re-adjust as required.

## How To Tune Your Delta-V™ Power Cables

1. First make sure that the timing and string cables are properly adjusted.
2. Using a Delta-V Bow Compressor, put light tension on the bow.
3. Correctly position one of the tip wheel axes in relation to the straight edge measurement by adjusting one of the two power cable adjusters on the cam nearest the tip wheel. Loosen the set screw and turn the adjuster with a 1/4" allen wrench. When the right measurement is reached, tighten the set screw and put equal tension on the other adjuster on the same cam.
4. Remove the bow from the compressor and check the measurements on both cams. Correct as required. Recheck measurements for String and Timing cables. Adjust as required.

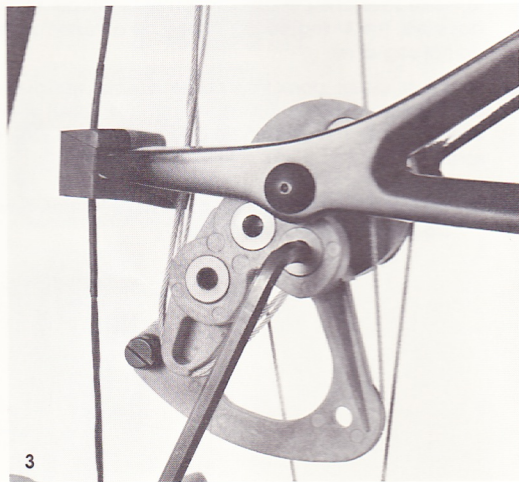

## How To Center The Cable Cage On Your Delta-V™

1. Using the bowstring for a centerline, make sure that each of the cable cages are bisected by the bowstring.
2. If one is out of line, adjust it by loosening the set screw on one of the power cable adjusters on the cam nearest the out-of-place cable cage.
3. Take in or let out cable with the power cable adjuster. Tighten the set screw.
4. Recheck measurements for string timing and power adjustment cables. Adjust as required.

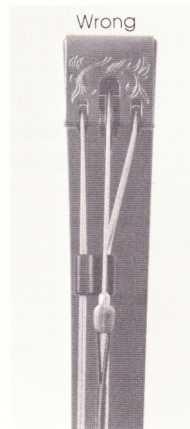
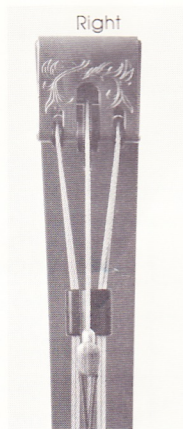



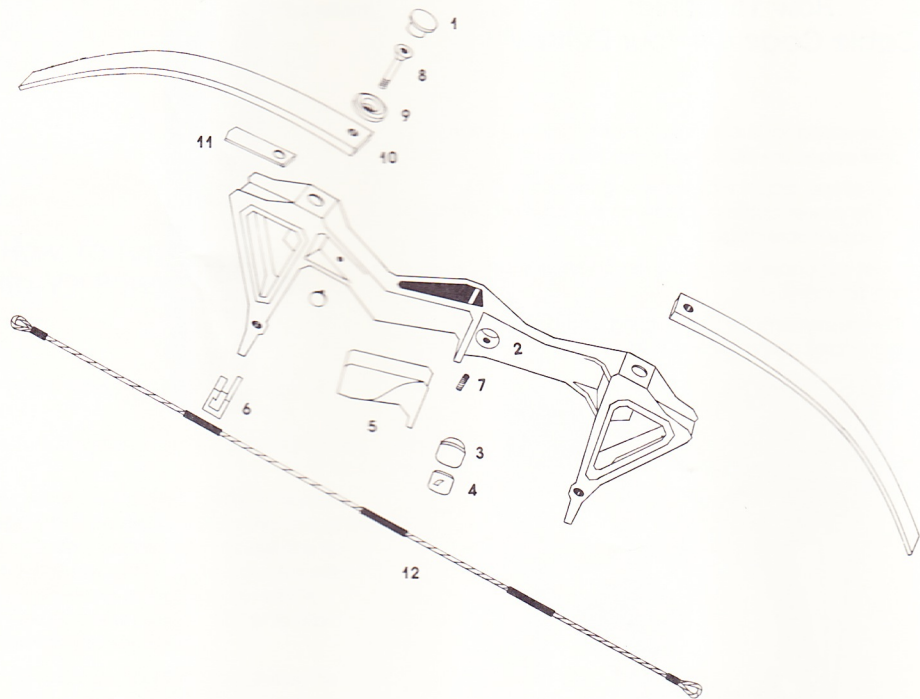

## Handle Assembly

Description	Catalog Number	Quantity Needed
1. Cover Plug	4996-000	2
2. Handle	RH-4994-100	1
	LH-4994-200	
3. Arrow Rest Carrier	4995-000	1
4. Arrow Rest (Weatherest)	RH-3545-100	1
	LH-3545-200	1
5. Grip	Low-RH-4958-100	1
	Low-LH-4958-200	
	High-RH-4959-100	
	High-LH-4959-200	
6. Power Bumper	4208-000	2
7. Carrier Set Screw	4197-000	1
8. Limb Bolt	4194-000	2
9. Limb Bolt Washer	4804-000	2
10. Nylon Limb Bolt Washer	4806-000	2
	4207-000	2
11. Limb Socket Pad	4207-000	2
12. Bowstring	4209-000	1

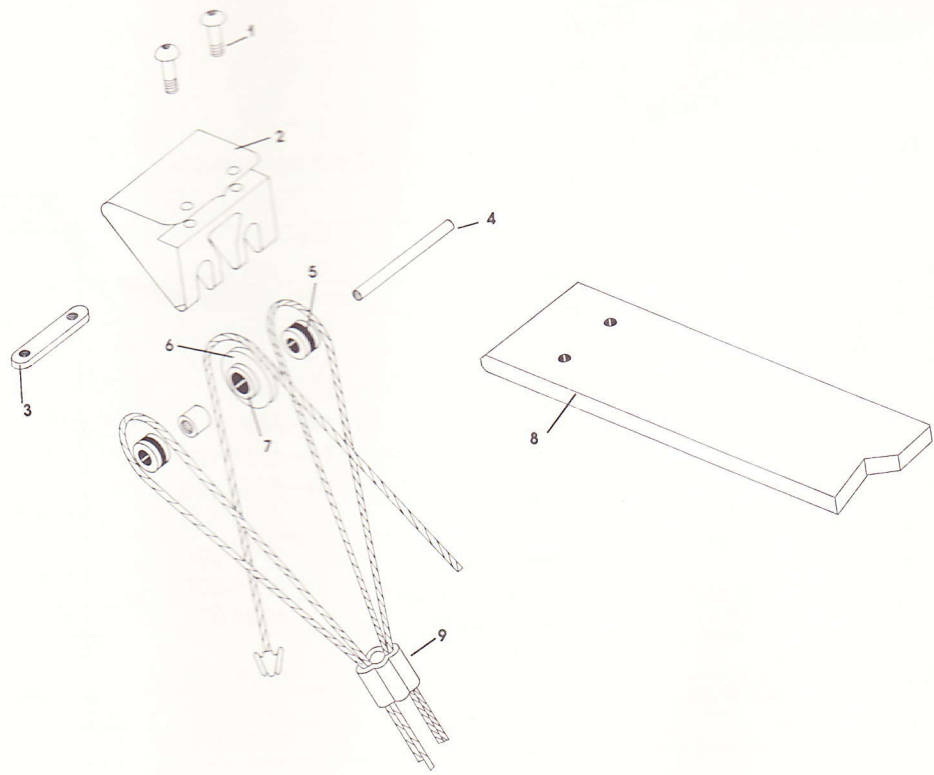

## Limb & Yoke Assembly

Description	Catalog Number	Quantity Needed
1. Tip Yoke Screw	4195-000	4
2. Tip Yoke	4204-000	2
3. Tip Yoke Plate	4205-000	2
4. Tip Wheel Axle	4190-000	2
5. Tip Wheel Axle Spool	4201-000	4
6. Tip Wheel	4200-000	2
7. Tip Wheel Bearing	4191-000	2
8. Limb	40#-4957-040 50#-4957-050 60#-4957-060 70#-4957-070	1 pair
9. Cable Cage	4889-000	2



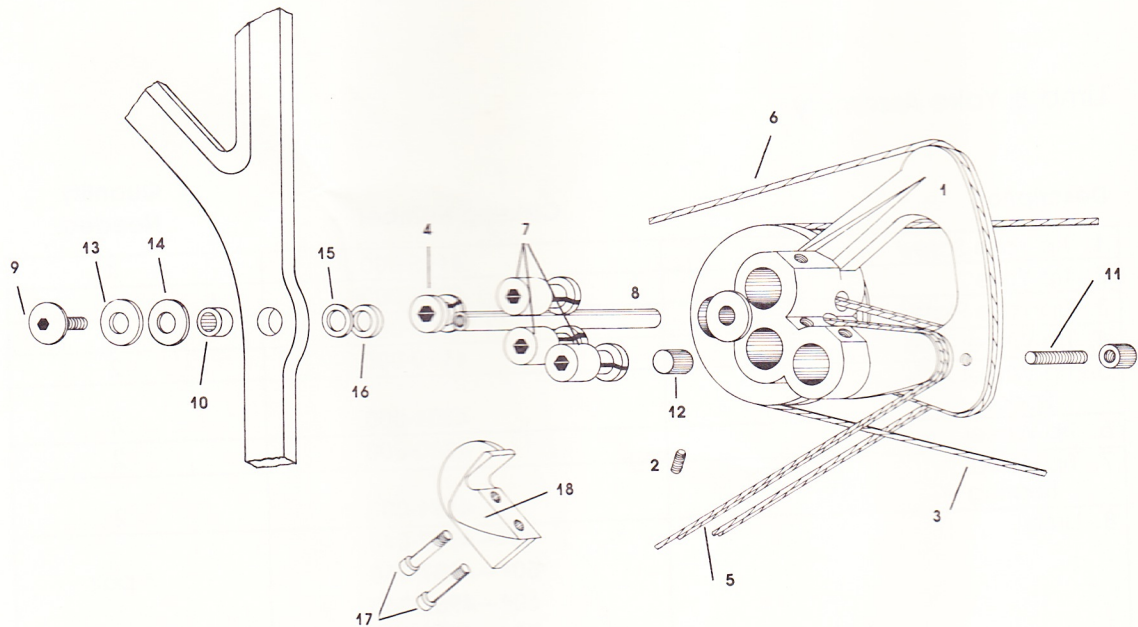

# Cam Assembly

Description	Catalog Number	Quantity Needed
1. Cam	Upper—4206-100 Lower—4206-200	1
2. Cable Adjuster Set Screw	4196-000	8
3. Timing Cable	4997-000	2
4. Timing Cable Adjuster	4198-000	2
5. Power Cable	4999-000	4
6. String Cable	4998-000	2
7. Power/String Cable Adjuster	4199-000	6
8. Cam Axle	4202-000	2
9. Cam Axle Screw	4203-000	4
10. Cam Axle Bearing	4887-000	2
11. Nylon Set Screw	4886-000	1
12. Nylon Thumb Nut	4885-000	2
13. .015 Outer Washer	4192-100	as required
14. .030 Outer Washer	4192-200	as required
15. .015 Spacer Washer	4193-100	as required
16. .030 Spacer Washer	4193-200	as required
17. Program Block Screw	4888-000	1
18. Speed/Draw Length Module	25"—4898-025 26"—4897-026 27"—4896-027 28"—4895-028 29"—4894-029 30"—4893-030 31"—4892-031 32"—4891-032 33"—4891-033	as required need pair

The Compound Bow, regardless of manufacturer, is a sophisticated product. If you are not mechanically inclined, or if you have difficulty of any nature with your Bear Compound Bow, we urge you to take it back to the dealer where you purchased it or to the nearest Authorized Bear Archery Service Center for their help and advice. A network of Authorized Bear Archery Service Centers has been set up across the country to provide you with assistance and warranty repair as required.



## Authorized Bear Archery Service Center

### ALABAMA

Beavers Archery Center  
Birmingham, AL 35212

Cricket Hall  
Albertville, AL 35950

Mary Carter Paint  
Cullman, AL 35055

Thoss Sporting Goods  
Mobile, AL 36616

Tri-State Dist.  
Midland City, AL

### ARIZONA

Henderson Archery  
Phoenix, AZ 85007

Kachina Archery, Inc.  
Phoenix, AZ 85029

### ARKANSAS

Archery World  
Texarkana, AR 75501

Custom Archery  
Little Rock, AR 72209

Haldon Archery  
Ft. Smith, AR 72904

The Archery Center  
Little Rock, AR 72204

### CALIFORNIA

Archery Headquarters  
El Monte, CA 91732

Arrow Manufacturing  
Costa Mesa, CA 92626

E & G Archery  
San Jose, CA 95126

Pony Express Sporting Goods  
Encino, CA 91316

### COLORADO

Colorado Archery & Bowhunting  
Denver, CO 80223

Sportsman Hut  
Monte Vista, CO 81144

William Tell Archery  
Colorado Springs, CO 80907

### FLORIDA

Atkinson Archery  
Pensacola, FL 32504

Florida Archery  
Gainesville, FL 32601

Southeastern Archery  
Orlando, FL 32806

### GEORGIA

Deercliff Archery Supplies  
Decatur, GA 30033

### ILLINOIS

Archery Custom Shop  
Forest Park, IL 60130

Chicago Archery Center  
Chicago, IL 60635

Griswold Archery Shop  
Cameron, IL 61423

Mike's Archery  
Irvington, IL 62848

Nock & Feather  
Aurora, IL 60504

Tomahawk Archery  
Springfield, IL 62702

#### **INDIANA**

Albertson's Sports Shop  
Warsaw, IN 46580

Blythe Sports Inc.  
Valparaiso, IN 46383

Joe Giacoletto Goodyear  
Clinton, IN 47842

Little John's Archery  
Ft. Wayne, IN 46804

Paul's Archery Center  
Muncie, IN 47302

Sutphins Archery  
Indianapolis, IN 46224

#### **IOWA**

Archery, Field & Sport  
Des Moines, IA 50311

Bowhunting Supplies  
Cedar Falls, IA 50613

Outdoor Ventures  
Fairfield, IA 52556

#### **KANSAS**

Randy's Taxidermy  
Burlington, KS 66839

#### **KENTUCKY**

Archery Craft  
Madisonville, KY 42431

Helman General Merchandise  
Melbourne, KY 41059

Kentucky Woodsman  
Ashland, KY 41101

McDannell's Sporting Goods  
Cynthiana, KY 41031

Pape's Hardware, Inc.  
Louisville, KY 40219

#### **LOUISIANA**

Able Archery  
Baton Rouge, LA 70814

Bowhunter's Haven  
Kenner, LA 70062

Cajun Archery  
New Iberia, LA 70560

Gene's Sporting Goods  
Monroe, LA 71201

#### **MAINE**

Cherokee Archery  
Stillwater, ME 04489

Kittery Trading Post  
Kittery, ME 03904

#### **MASSACHUSETTS**

Forest Orchard Archery  
Northboro, MA 01532

Hilltop Archery  
Webster, MA 01547

#### **MICHIGAN**

Anderson Archery Sales  
Grand Ledge, MI 48837

Bear Archery Center  
Grand Rapids, MI 49584

Cook's Sportland, Inc.  
Monroe, MI 48161

Floyd's Bait & Tackle  
Flint, MI 48504

Great Outdoors  
Muskegon, MI 49442

Hunters Shack  
Flint, MI 48507

Springer Archery Supply  
Romulus, MI 48174

Spring's Sporting Goods  
Muskegon, MI 49440

Starlight Archery  
Warren, MI 48089

Starlight Archery  
Kalamazoo, MI 49002

Superior Archery  
Jackson, MI 49203

#### **MINNESOTA**

Archery Hut  
Robbinsdale, MN 55442

Bwana Archery  
St. Paul, MN 55106

H & H Sport  
Maple Lake, MN 55358

Metro Archery  
Blaine, MN 55434

Tom's Archery Shop & Lanes  
Excelsior, MN 55331

#### **MISSISSIPPI**

Big Buck Trading Post  
Hattiesburg, MS 39401

Blackledge Discount Drugs  
Bay Springs, MS 39422

Daniel's Den  
Moss Point, MS 39563

Leisure World of Meridian  
Meridian, MS 39301

Outdoor Outfitters  
McComb, MS 39648

Rebel Sport Goods  
Terry, MS 39170

Straight-N-Arrow, Inc.  
Brandon, MS 39402

#### **MISSOURI**

Beard's Sporting Goods  
Cape Girardeau, MO 63701

Bowhunters Pro Shop  
Springfield, MO 65807

Neet Products, Inc.  
Sedalia, MO 65301

Pemberton Archery & Supply  
Pacific, MO 63069

#### **NEBRASKA**

Dubs, Inc.  
Kearney, NE 68847



Elkhorn Archery  
Norfolk, NE 68701  
Midwest Custom Sports  
Omaha, NE 68107

#### NEVADA

Nevada Archery  
Las Vegas, NV 89102

#### NEW HAMPSHIRE

Al's Archery  
Hooksett, NH 03106

#### NEW JERSEY

Butts & Bows  
Belleville, NJ 07109  
Mt. Ephraim Archery  
Mt. Ephraim, NJ 08059  
The Sportsman's Center  
Bordentown, NJ 08505  
Wilderness Archery  
Dover, NJ 07801

#### NEW YORK

Archery Outfitters  
Rochester, NY 14616  
Baker's Sporting Goods  
Barneveld, NY 13304  
Belmont Archery  
Belmont, NY 14813  
Bison Archery Service, Inc.  
Buffalo, NY 14210  
Dave's Bowhunting  
Niagara Falls, NY 14302  
Ed Hart's Gun Supply  
Bath, NY 14810  
Ethan Allen Archery Equip.  
Port Ewen, NY 12466  
G E M Sport Supply  
Syracuse, NY 13203  
Lemme's Archery Shop  
Albany, NY 12210  
Menand's Archery Den  
Albany, NY 12204

Playtogs, Inc.  
Middletown, NY 10940  
Professional Archery Service  
Niagara Falls, NY 14303  
Wildwood Archery Lanes  
Memphis, NY 13112

#### NORTH CAROLINA

Barefoot Archery  
Charlotte, NC 28208  
Franklin Rod & Guns  
Asheville, NC 28806  
Graham Archery Sales  
Salisbury, NC 28144  
Hunter Haven Gun Shop  
High Point, NC 27263  
J & M Archery  
Bessemer City, NC 28016  
Sportsman's Specialty  
N. Wilkesboro, NC 28659  
The Sport Shop  
Grifton, NC 28530

#### NORTH DAKOTA

G & G Sporting Goods  
Grand Fork, ND 58201

#### OHIO

Flying Feathers Arrows  
Fulton, OH 43321  
J. M. F. Sports Supply  
Massillon, OH 44646  
Kowalka's Gun & Archery  
Northwood, OH 43619  
Olde Hunter's Supply  
Washingtonville, OH 44490  
Parson's Sport Shop  
Bowling Green, OH 43402  
Portage Archery  
Suffield, OH 44260  
Primitive Weapons Arena  
Milford, OH 45150

Reiff Sports Supply  
Lima, OH 45805  
Sportfame III  
Northwood, OH 43619

Sportfame, Inc.  
Toledo, OH 43623  
Starlight Archery  
Euclid, OH 44117  
The Tackle Box  
Toledo, OH 43612  
Victor Bergers World/Archery  
Springfield, OH 45503  
Warren Archery Distributor  
Warren, OH 44483  
Xenia Archery Center  
Xenia, OH 45385

#### OKLAHOMA

Lawg Caybun  
Coweta, OK 74429  
Norman Archery  
Norman, OK 73069  
Oklahoma Archery Center  
Oklahoma City, OK 73129  
Pat's Archery & Sporting Goods  
Okmulgee, OK 74447

#### PENNSYLVANIA

Blair Sporting Goods  
Williamsport, PA 17702  
Bowhunter's Warehouse  
Wellsville, PA 17365  
Brady's Sport Shop  
Millersburg, PA 17061  
Bucks & Bows Archery Lanes  
Pittsburgh, PA 15215  
Deer Creek Archery  
Hadley, PA 16130  
Del's Archery  
Media, PA 19063  
Emery's Archery Specialists  
Butler, PA 16001

Esh's Archery  
Intercourse, PA 17534

Feline Archery  
Greensburg, PA 15601

Kinsey's Archery  
Mt. Joy, PA 17552

Stone's Sport Center  
Bridgeville, PA 15017

Trojan Archery Shop  
Waynesboro, PA 17268

Weaknecht Archery  
Kutztown, PA 19530

#### **SOUTH CAROLINA**

Ole Norm's Bldg. Supply  
Clemson, SC 29607

Ray's Archery Shop  
Taylors, SC 29687

#### **SOUTH DAKOTA**

Bledsoe's Archery Den  
Sioux Falls, SD 57103

The Outdoorsman  
Rapid City, SD 57701

#### **TENNESSEE**

Ace Hardware  
Dunlap, TN 37327

Bill Dyer Supply Co. Inc.  
Paris, TN 38242

Bull's Eye Archery Shop  
Bartlett, TN 38134

Cherokee Marine, Inc.  
Bean Station, TN 37708

Mahoneys Sportsmans Paradise  
Johnson City, TN 37601

Sportsman's Tackle  
Chattanooga, TN 37146

#### **TEXAS**

Archery Sports Co.  
Pasadena, TX 77506

East Texas Archery  
Kilgore, TX 75662

Hillcrest Archery  
Houston, TX 77055

#### **UTAH**

Consolidated Field Sports  
Salt Lake City, UT 84115

Rocky Mountain Archery  
Sandy, UT 84070

#### **VERMONT**

Moe's Bows  
Colchester, VT 05446

St. John's Sport Goods  
Fair Haven, VT 05743

#### **VIRGINIA**

Cox Archery Company  
Chilhowie, VA 24319

#### **WASHINGTON**

Foxe & Myers Sporting Goods  
Marysville, WA 98270

Northwest Archery Co.  
Seattle, WA 98148

#### **WEST VIRGINIA**

Anglers Roost  
Summersville, WV 26651

Mack & Dave's  
Huntington, WV 25722

Mountaineer Sports, Inc.  
Elkins, WV 26241

Spark's Sport Center  
Martinsburg, WV 25401

West Virginia Archery  
S. Charleston, WV 25309

#### **WISCONSIN**

Arrowhead Archery Lanes  
Green Bay, WI 54303

Automatic Archery Lanes  
Madison, WI 53722

Midway Archery Lanes  
Menasha, WI 54952

Tackle Box  
Wausau, WI 54401

The Outfitter  
Minacqua, WI 54548

West Town Archery  
Milwaukee, WI 53213

#### **WYOMING**

Butler's Archery  
Evanston, WY 82930

Dean's Sporting Goods  
Casper, WY 82601

---

## Warranty For Your Delta-V™

---

### Full One Year Warranty

Your Bear Bow is a quality designed and made product. It is warranted against defects in materials (exclusive of string and cables, if any) and workmanship for a period of one (1) year from date of purchase. If within such one (1) year period, a defect shall occur and such defect shall not result from modification of the bow, misuse or improper stringing, Bear will at its option and without cost to you, repair or replace the bow.

To obtain service on any Bear bow **other** than a compound, return it, shipping prepaid to Bear Archery, Attn: Factory Customer Service Department, R.R. 4, 4600 S.W., 41st Blvd., Gainesville, Florida 32601.

To obtain service on a Bear Compound bow, you may send or take it to the nearest Authorized Bear Service Center.

### Limited Five (5) Year Super Bearglas™ Limb Warranty

SUPER BEARGLAS™ Limbs, a product of Bear's advanced technology, are made by embedding fiberglass in an epoxy-based resin matrix which produces a limb having superb strength and durability. The limbs are warranted to the original purchaser of the bow against defects in materials and workmanship for five (5) years from the date of purchase. If within such period a defect occurs in a limb which shall not have resulted from modification of the bow, chemical contamination or misuse. Bear will, free of charge, replace the limb.

To obtain service on the limbs, merely take or send the bow postpaid to the authorized Bear Archery Warranty Service Center nearest you. Be sure to attach to the bow your name, address and telephone number, and include proof of the date of retail purchase such as a sales slip. This warranty gives you specific legal rights and you may also have other rights which vary from state to state.